

Contents

1 Important safety and product instructions.....	5
1.1 Preface.....	5
1.2 Product information.....	5
1.3 Copyright.....	5
1.4 Manual contents.....	5
2 Seismic anchoring requirements.....	6
3 Seismic anchor locations - dimensions.....	7
4 Seismic kit contents.....	8
5 Tools required.....	9
6 Install the seismic anchoring.....	10
7 Install the seismic anchoring (retrofit).....	14

1 Important safety and product instructions

1.1 Preface

This instruction manual describes the installation of the product. Everyone involved in installing the product must read and understand the contents of the installation and safety instructions.

This instruction manual gives you necessary information for the correct installation of the product.

For complete product and safety instructions, see **help.framery.com**.

1.2 Product information

The information in this manual corresponds to the product at the time of delivery. All information included in this manual is valid at the time of publication.

1.3 Copyright

This document must not be copied, presented, or delivered to a third party without explicit permission from Framery. The use of this document for any purpose other than those allowed by Framery is prohibited. Framery reserves the right to change the instructions related to the product without separate notice.

1.4 Manual contents

The installation instructions contain the following information:

- General information about the purpose and content of the instructions
- Information related to safety
- Installation instructions

2 Seismic anchoring requirements

**Note:**

When installing the product, take into consideration all local laws, rules and regulations concerning seismic anchoring and seismic safety.

For installations in the U.S., in buildings located in Seismic Design Categories A and B, anchoring to the floor is optional. In buildings located in Seismic Design Categories C, D, E or F, anchoring to the floor is required.

When anchoring to the floor, plans that address seismic design categories must be prepared by a registered design professional. The plans are to include definitions on the type, size and location of anchors and installation limitations. Additionally, installation must be in accordance with the applicable codes [IBC, IFC, IMC, NFPA 70 and, when installed with a sprinkler, NFPA 13].

3 Seismic anchor locations - dimensions

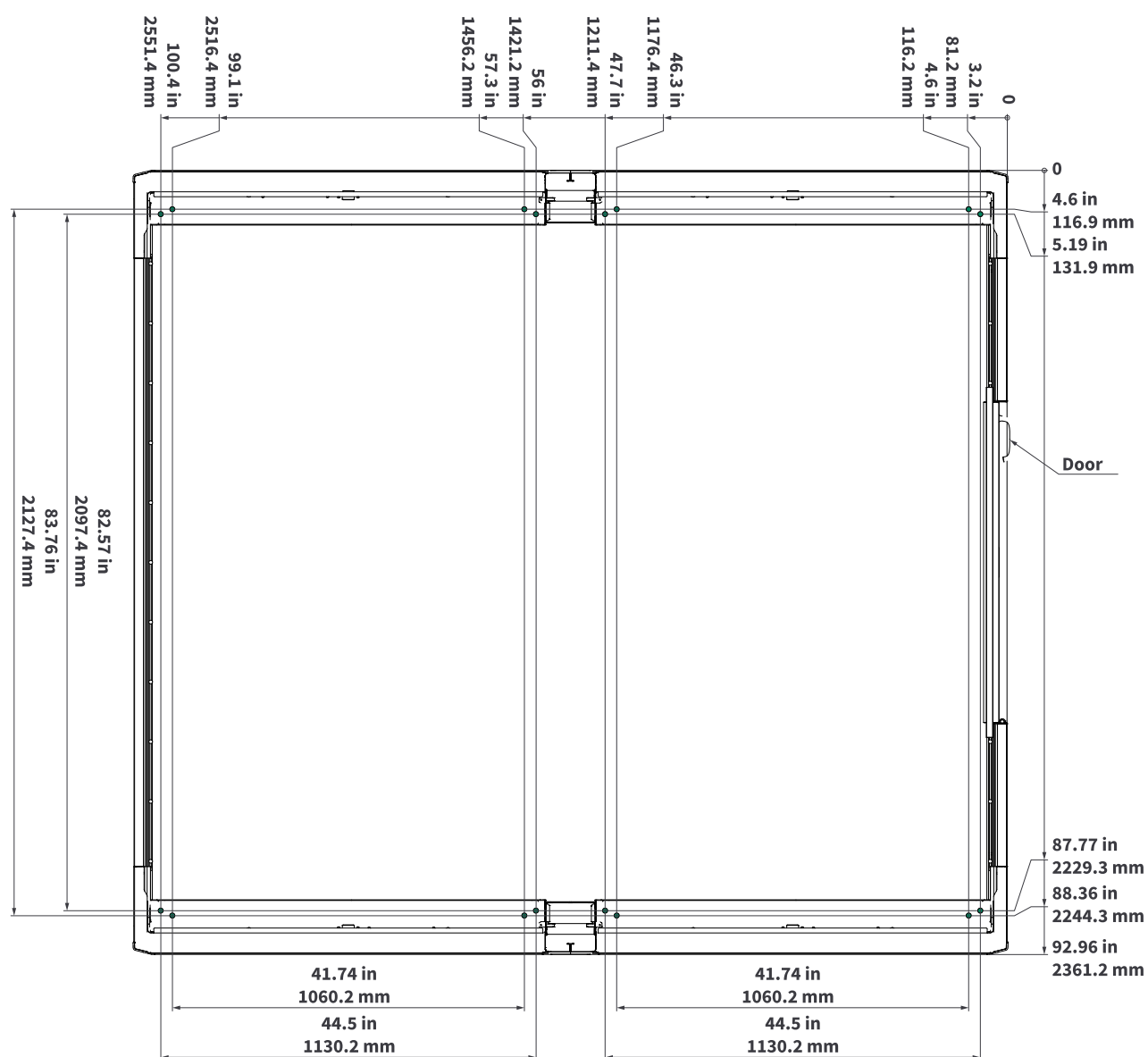

Figure 1: Framery Six seismic anchoring dimensions

4 Seismic kit contents

Seismic anchors are NOT included in the seismic installation kit. Seismic anchors must be selected and sized by a licensed Professional Engineer based on the floor construction of the building in which the pods are installed.



Note: Special inspection also may be required depending on the requirements of the local jurisdiction.

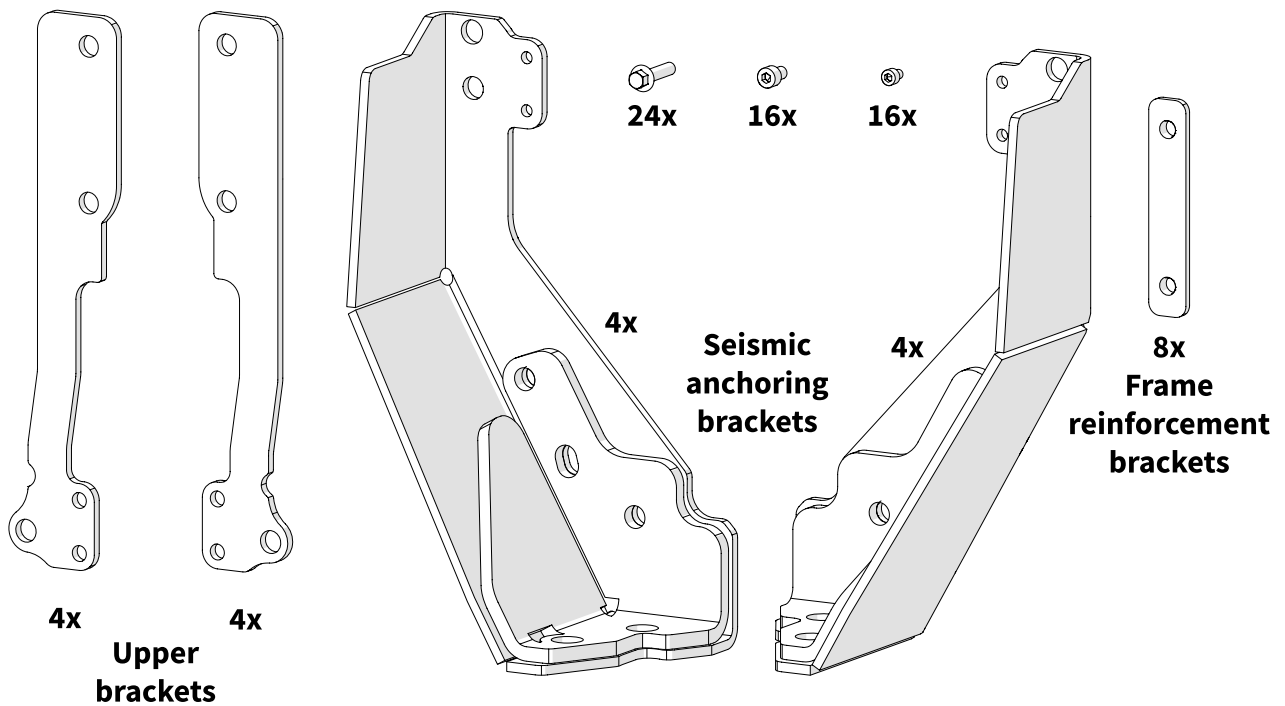
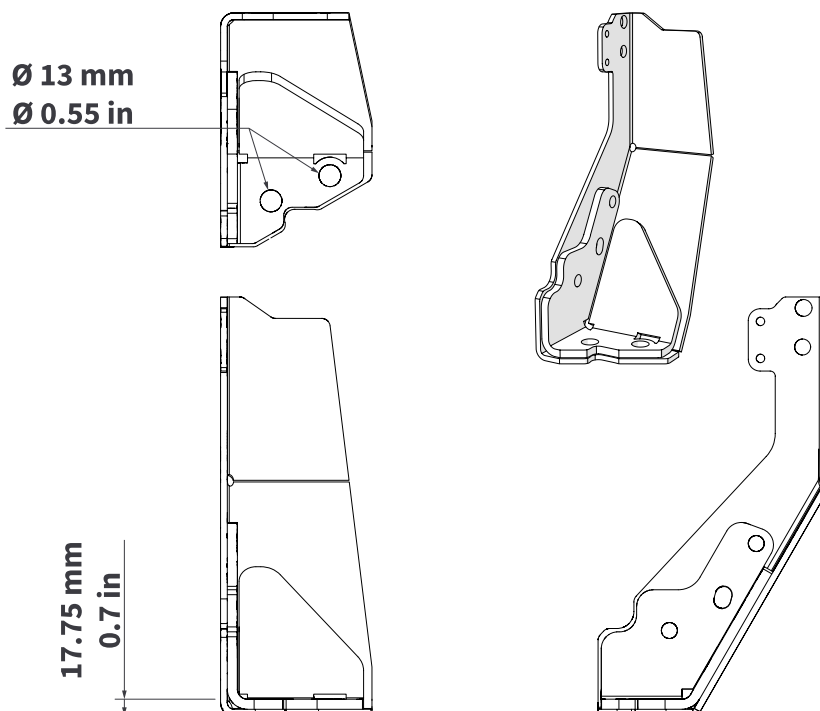

Figure 2: Framery Six seismic kit



5 Tools required



Note: Rotary hammer drill is recommended for drilling into concrete. Drill bit size is based on the anchor selected.

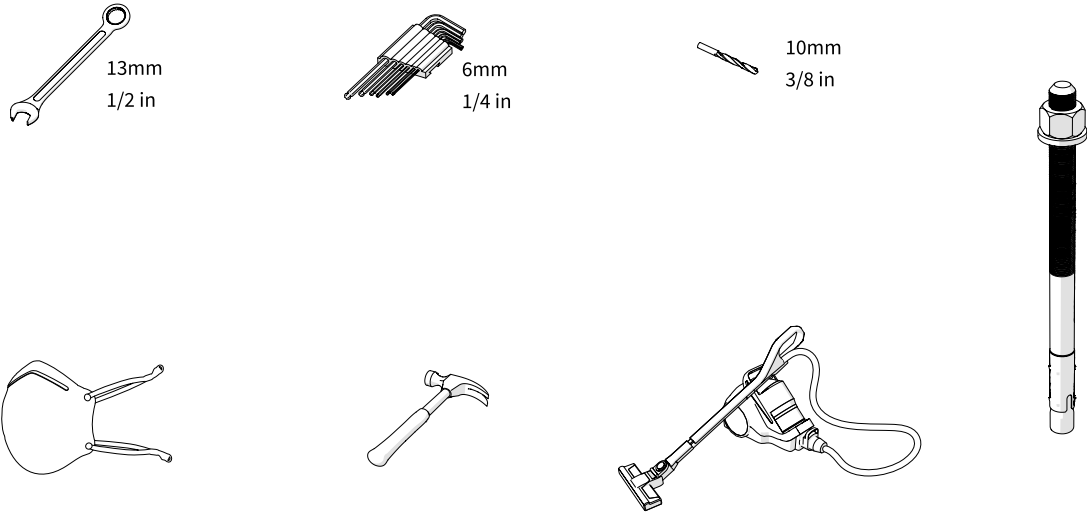

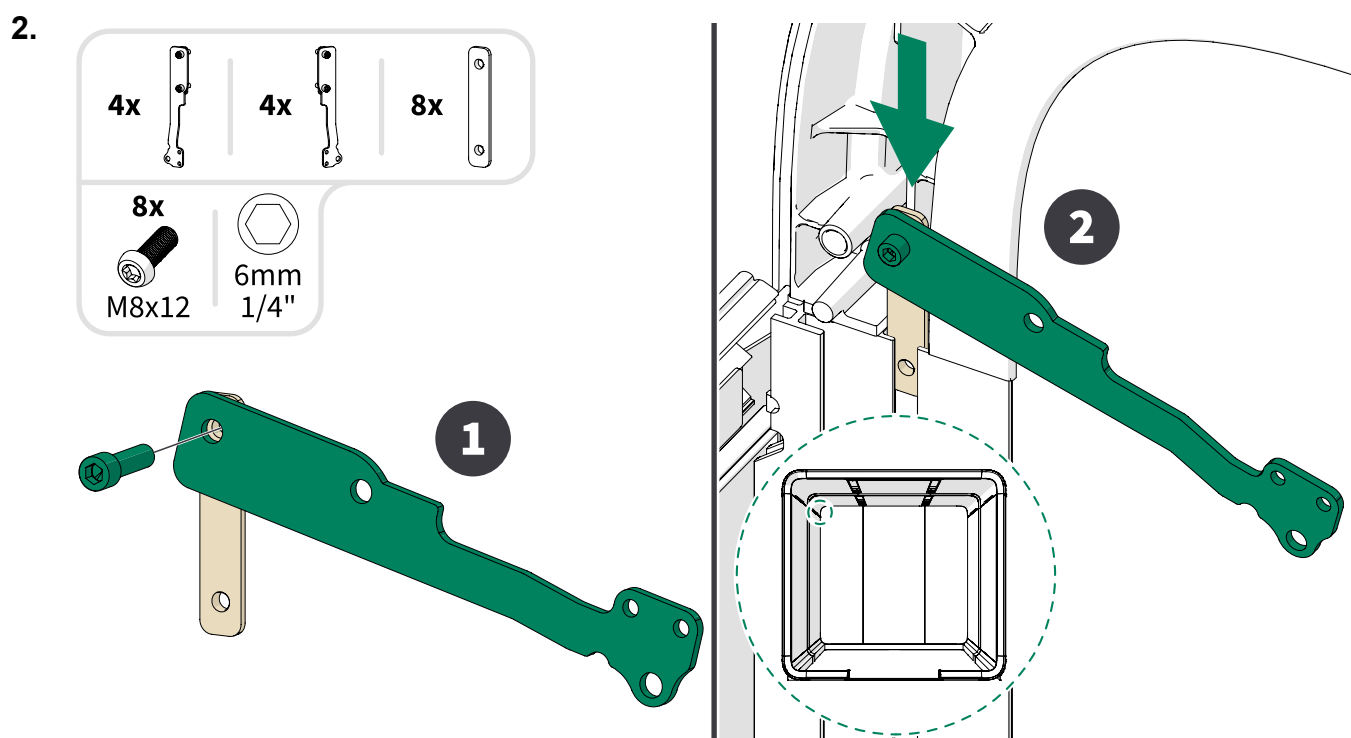
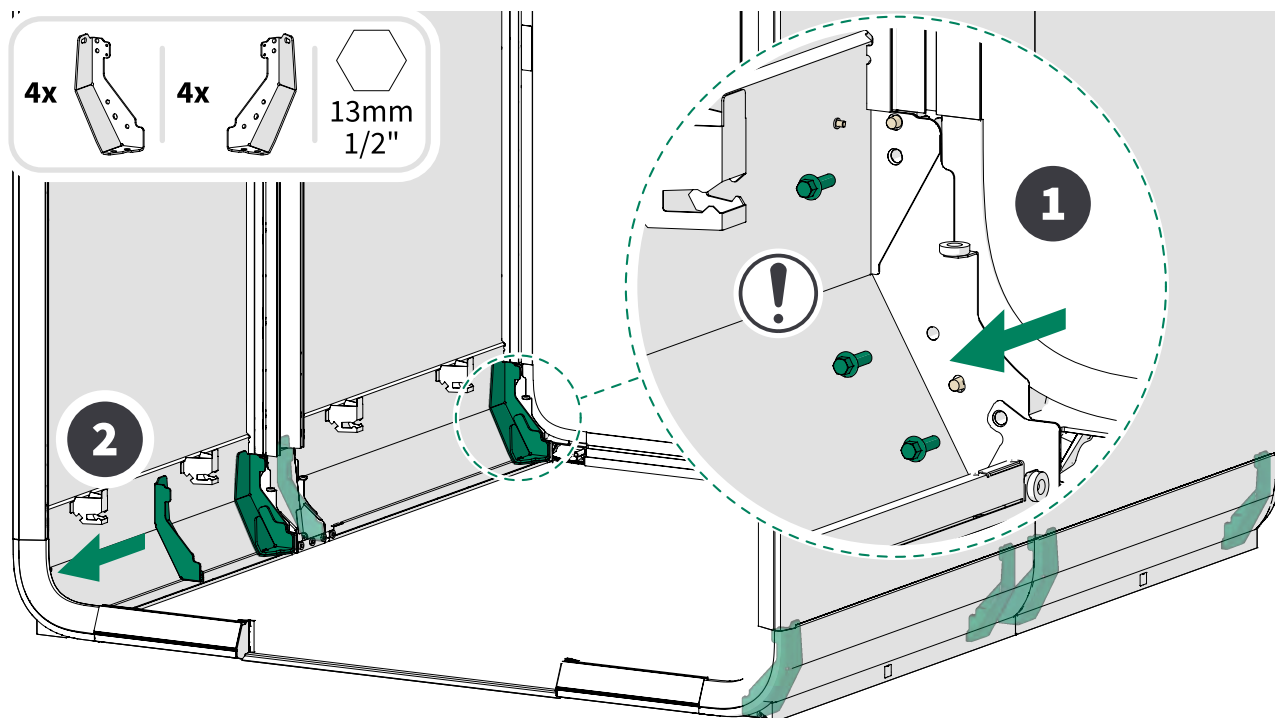

Figure 3: Tools required for seismic anchoring

6 Install the seismic anchoring

Assemble the pod chassis according to the installation instructions.

1.  **Warning:** Work on and finish one corner at a time. Do not unscrew more than one corner at a time.



3.

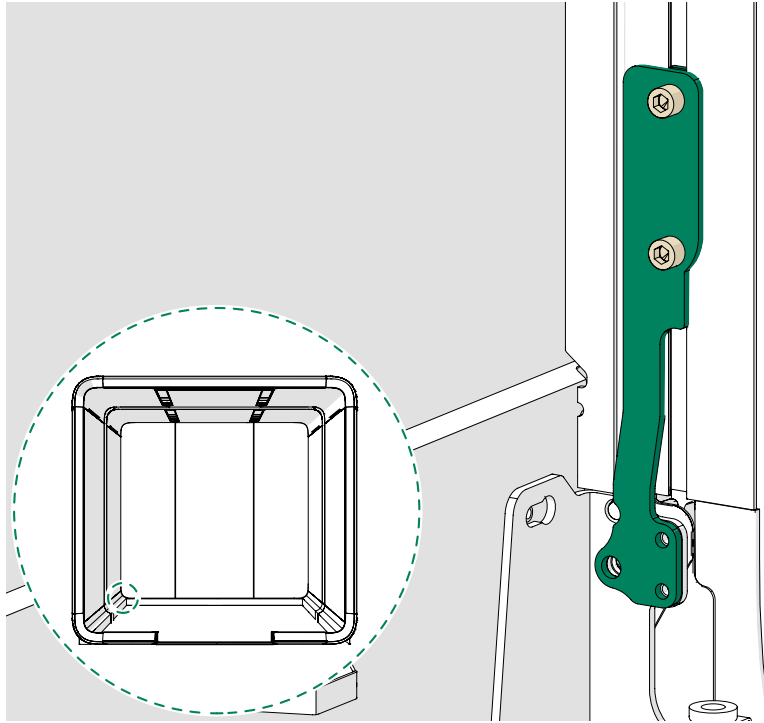

4.

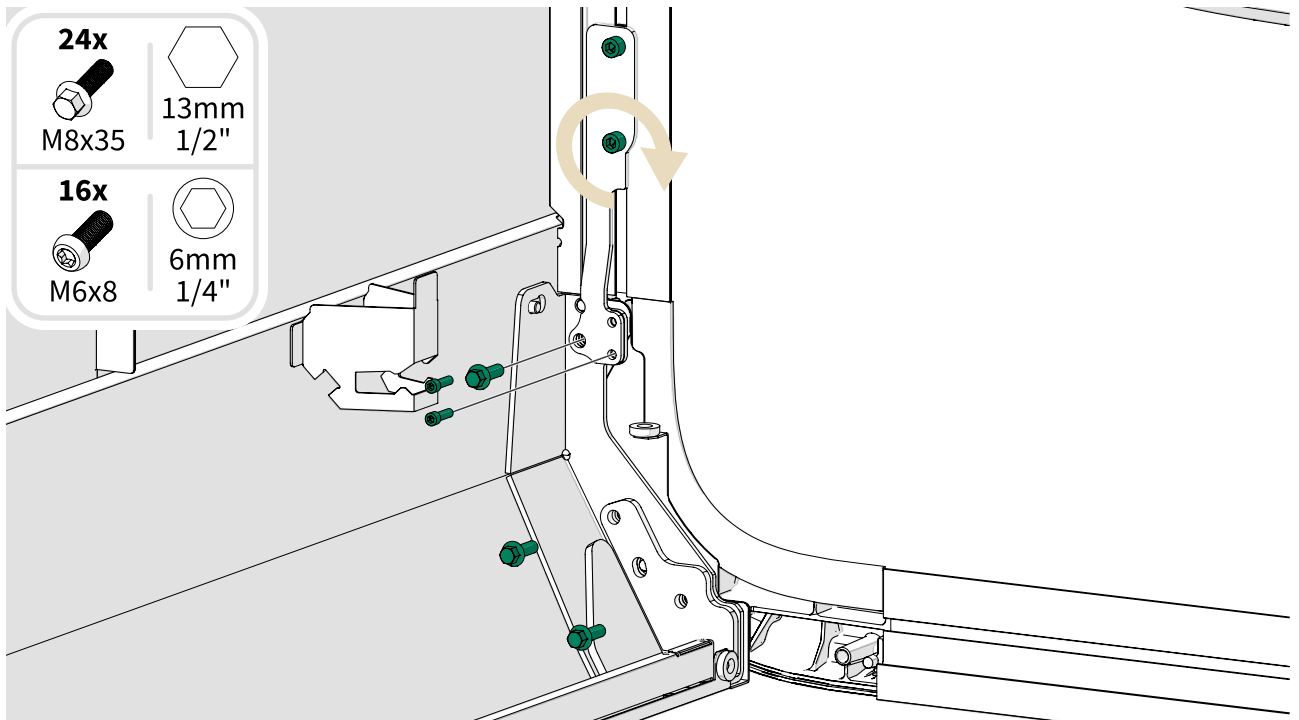

5. Drill holes for the anchors.

Verify the required hole depth with anchor guidelines.



Note: Drill bit size is based on the anchor selected.

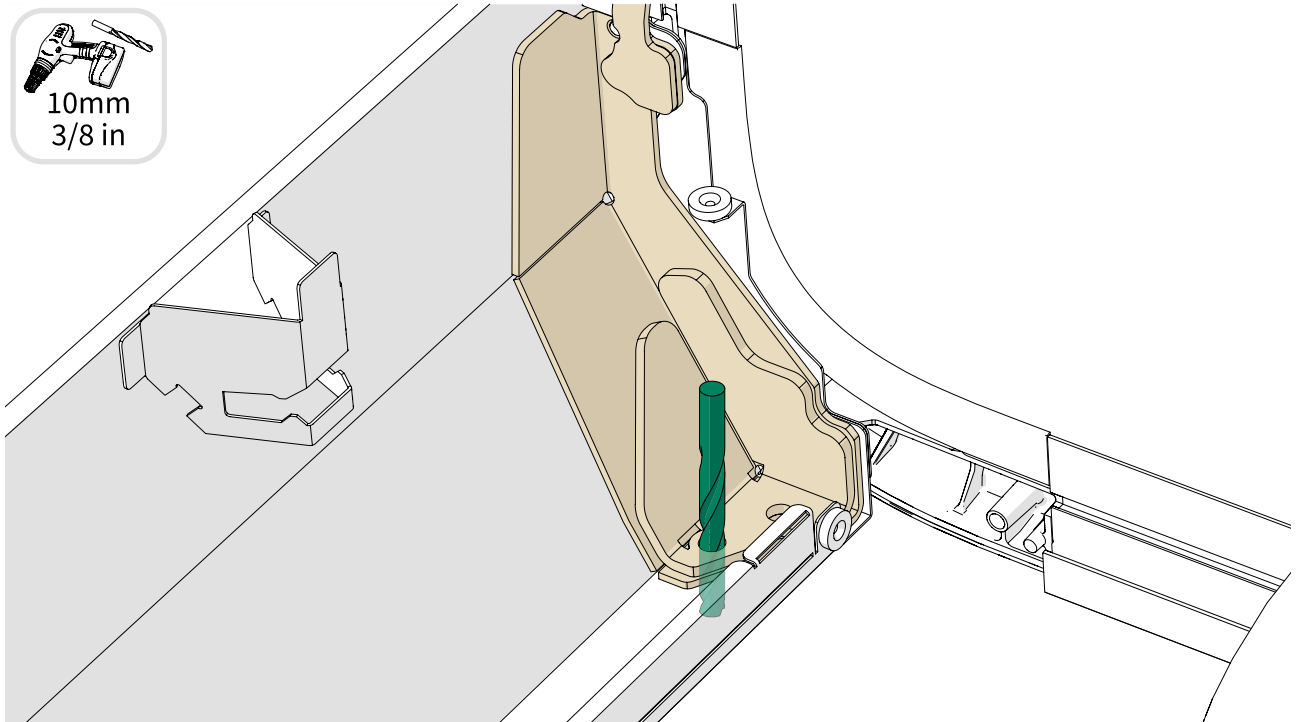

6. Clean the drilled holes according to anchor guidelines.

7. Install the anchors.

The thickness of the seismic anchoring brackets is 0.7 in (17.8 mm). The hole diameter in the brackets is 0.55 in (13 mm)



Note: You can use either of the two holes. (Wood floors may require both holes to be used.)



Note: The anchors are not included.

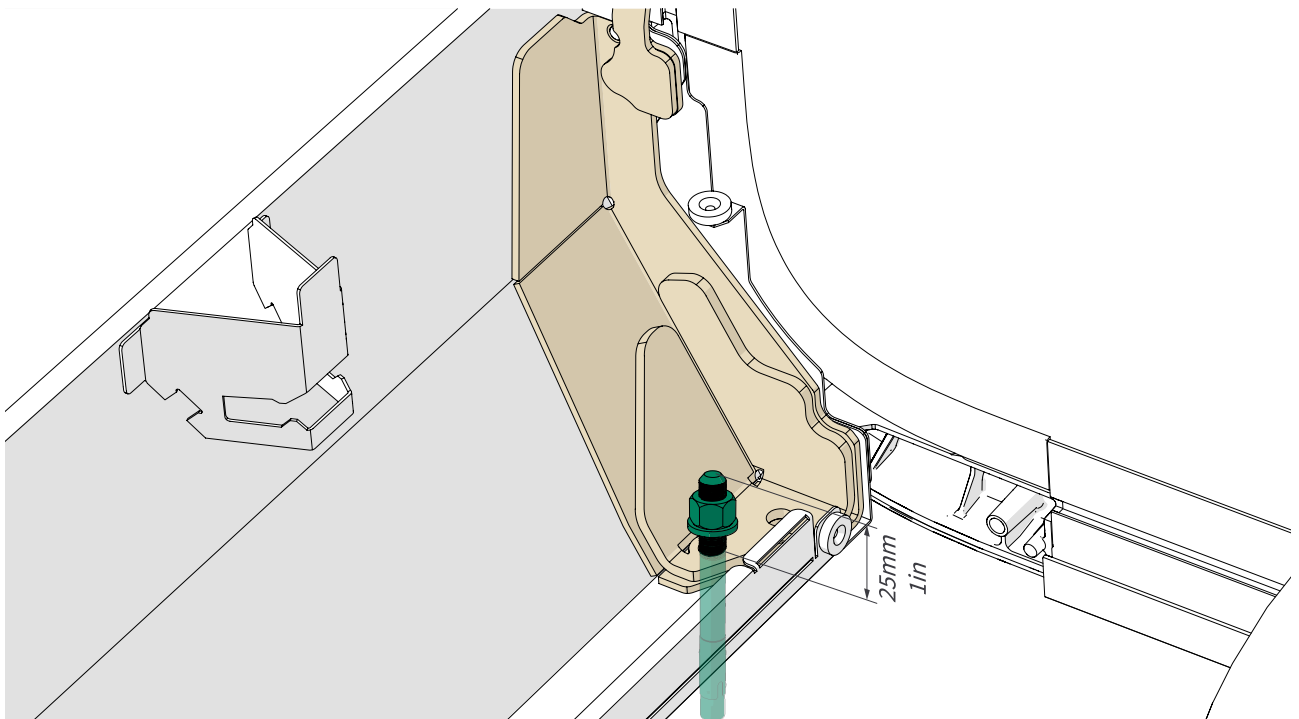

8. The anchors should be torqued to bolt manufacturer's guidelines. It is important to check both the bolt manufacturer's literature and the Professional Engineering calculations for this project.
9. Continue the pod installation according to the installation instructions.

7 Install the seismic anchoring (retrofit)

1.  **Note:** Whiteboard is an option.

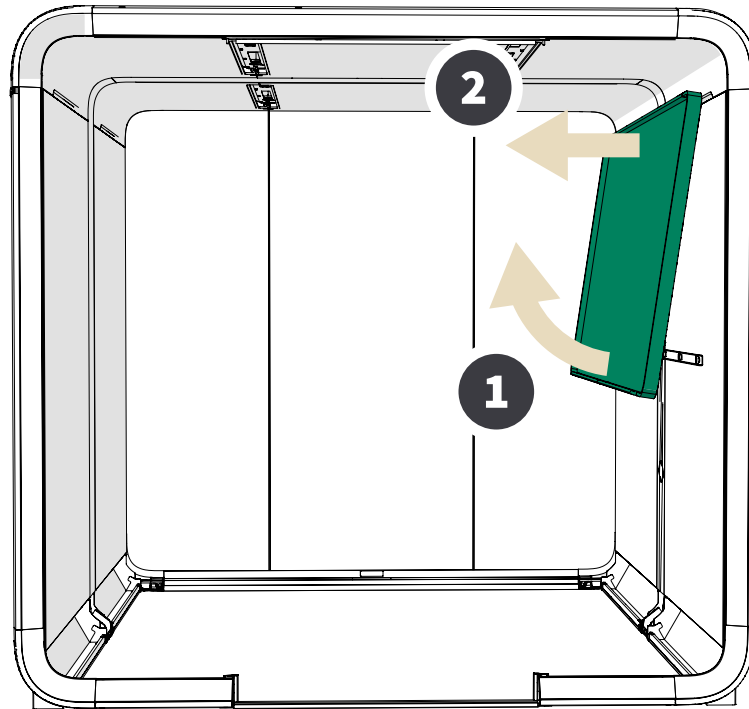

- 2.

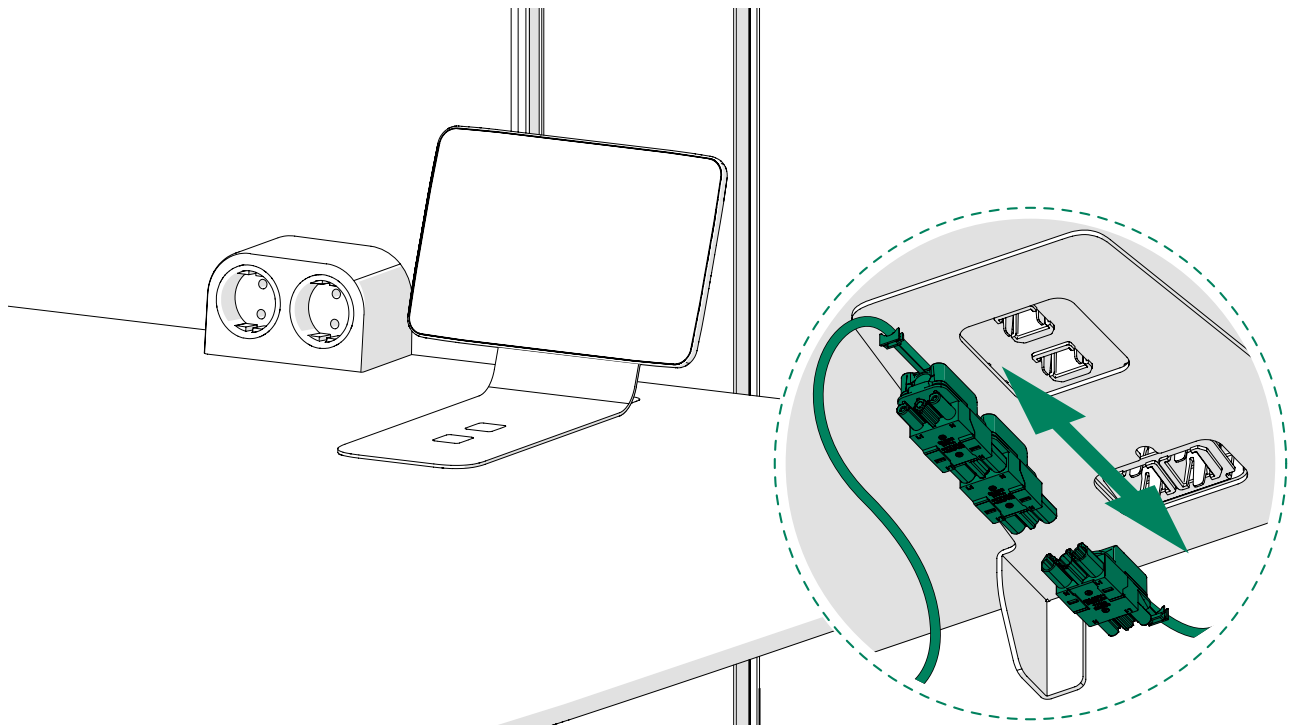

3.

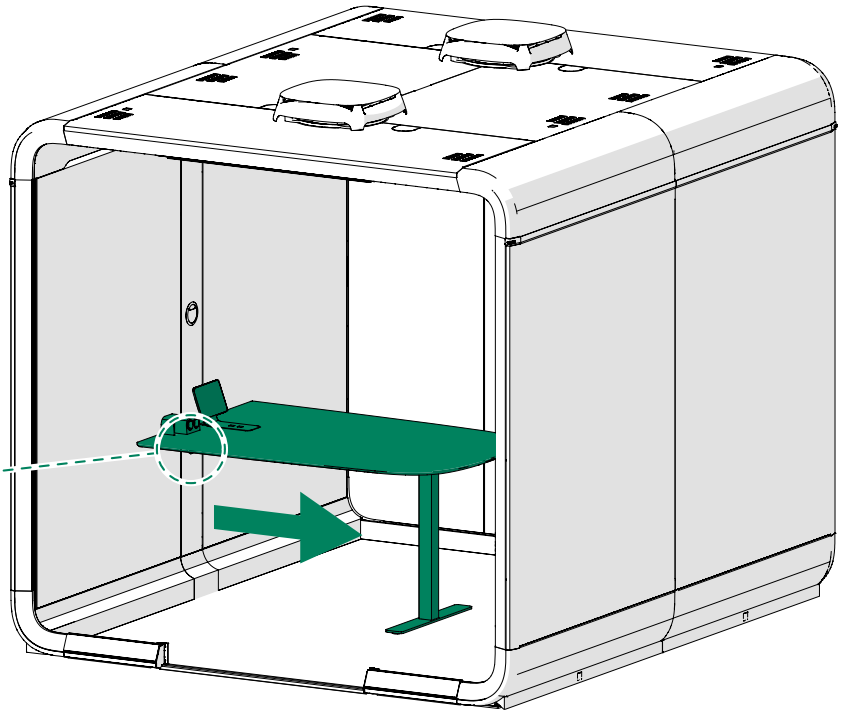
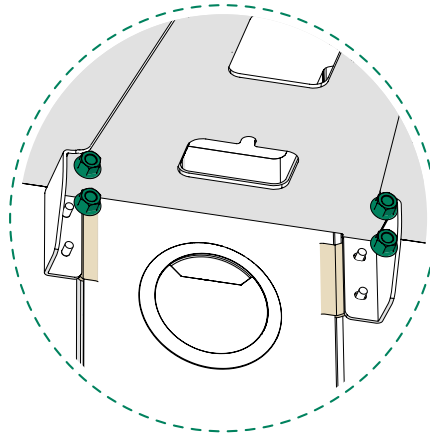
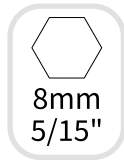

4.



Note: Make sure to protect the gaskets from dirt during the assembly.

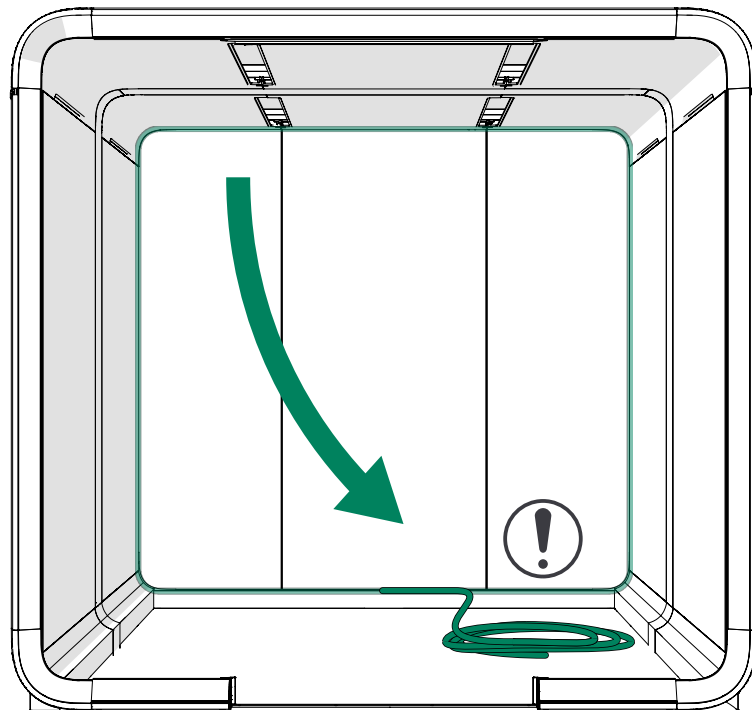

5.  **Note:** Make sure to protect the gaskets from dirt during the assembly.

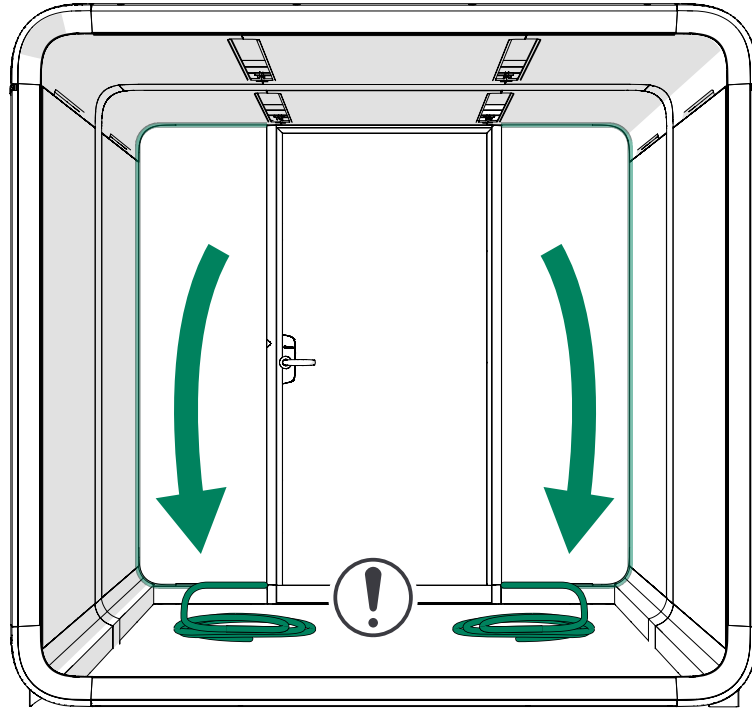

- 6.

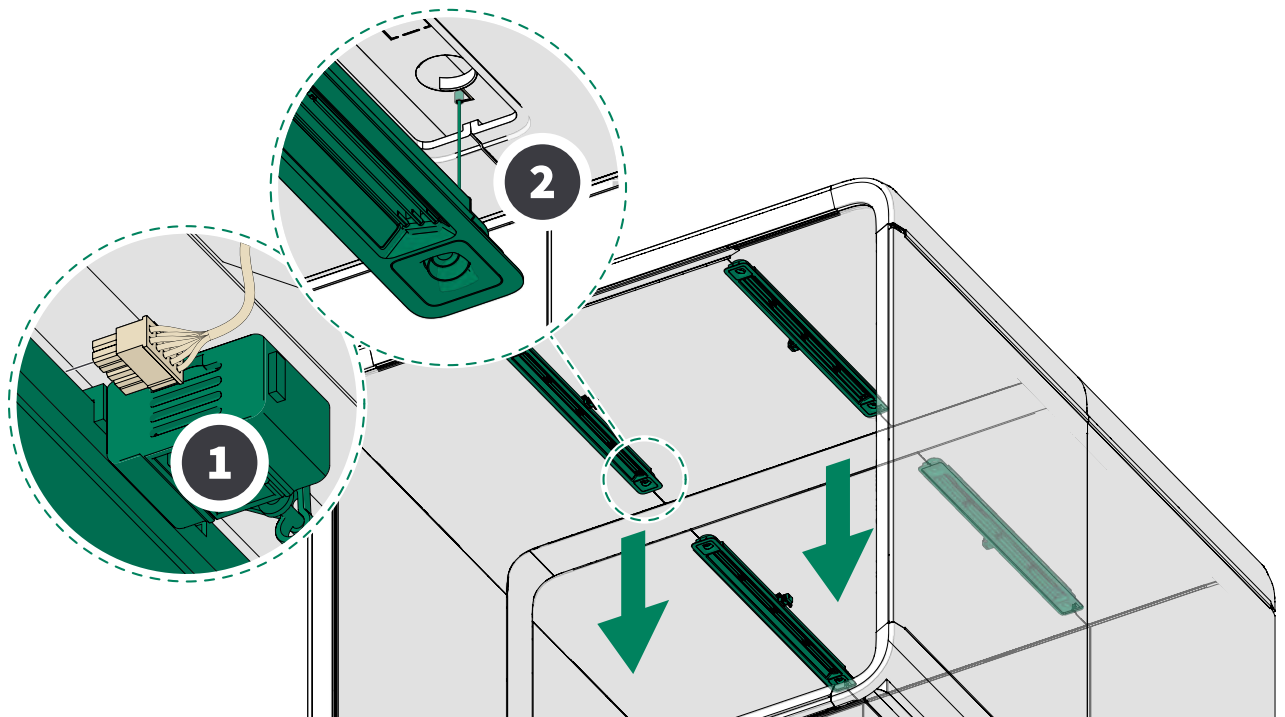

7.

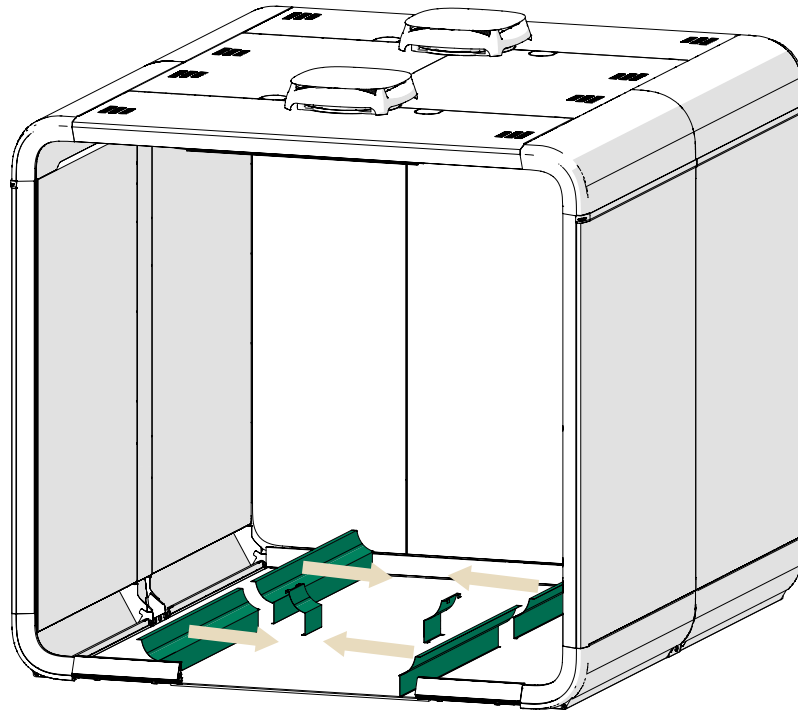

8.

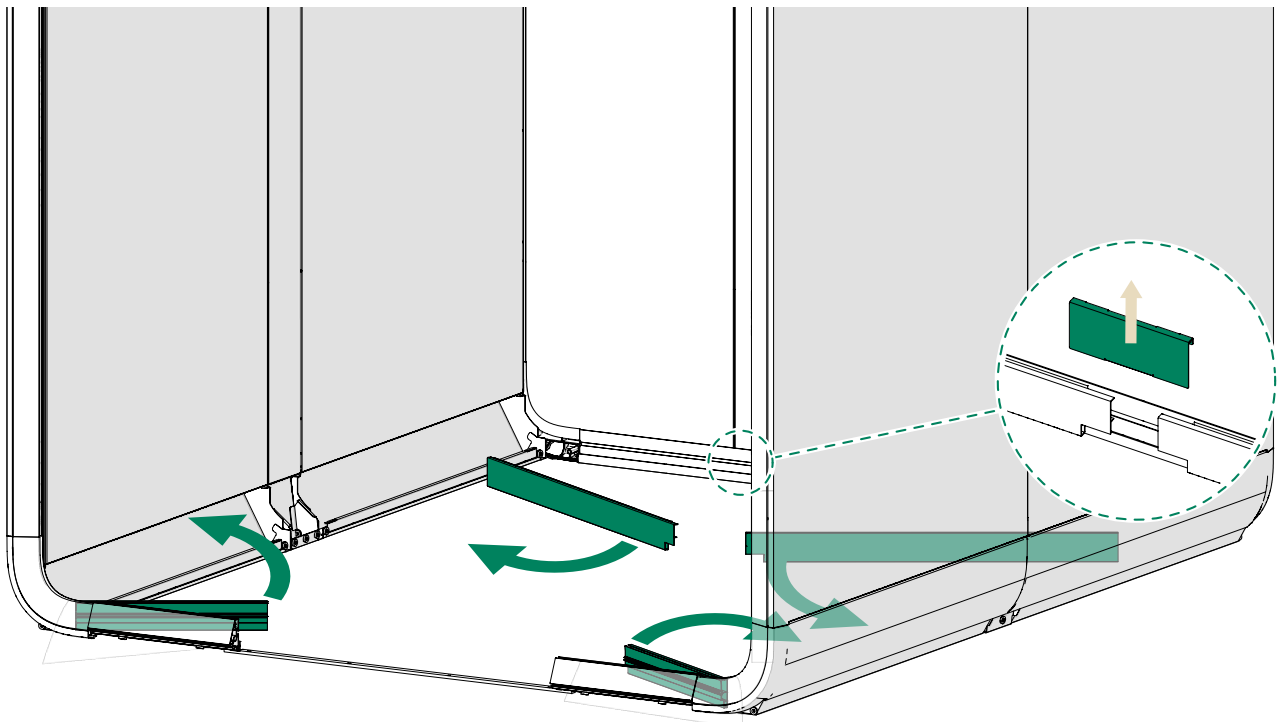

9.

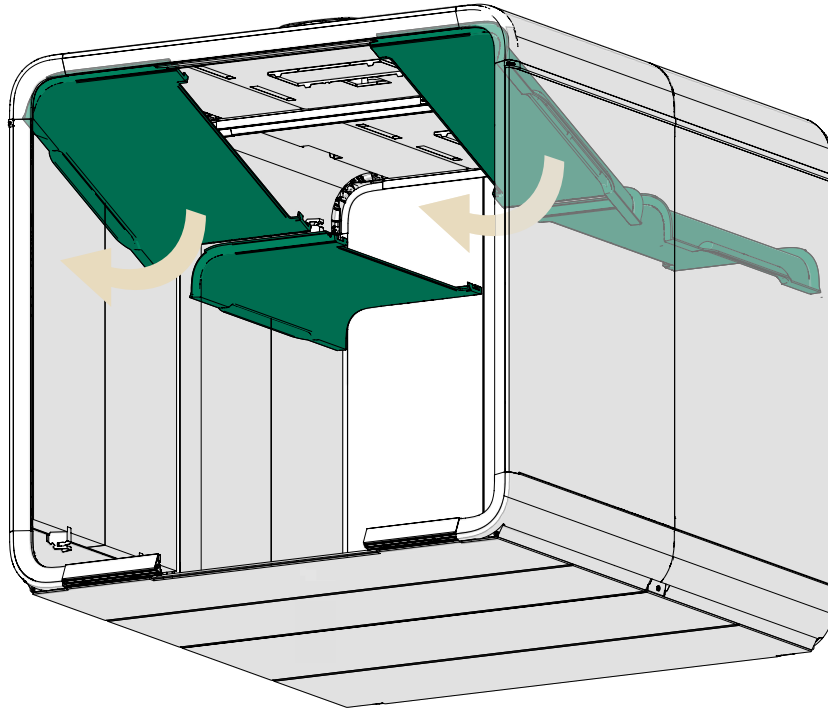

10.

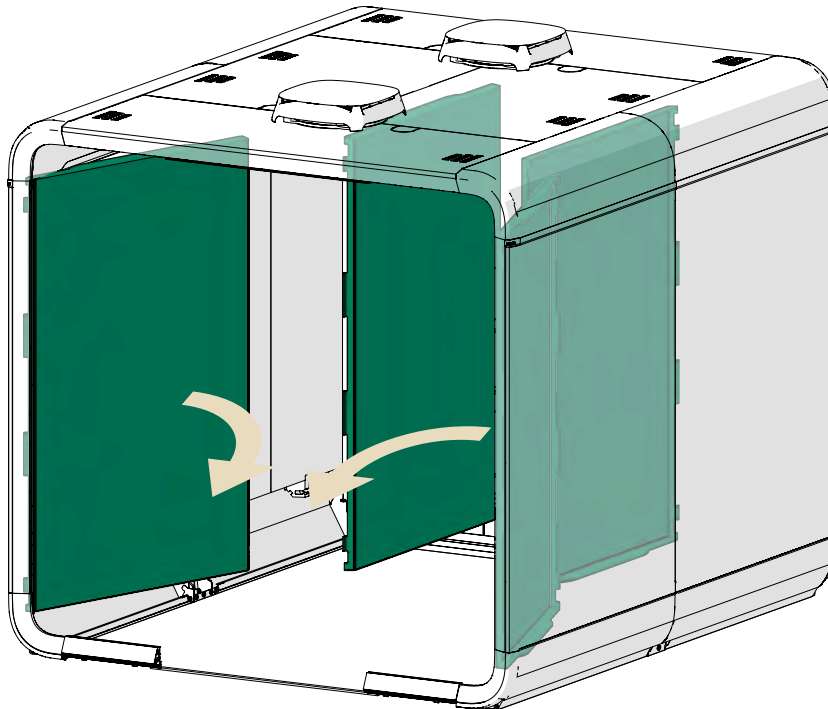

11.

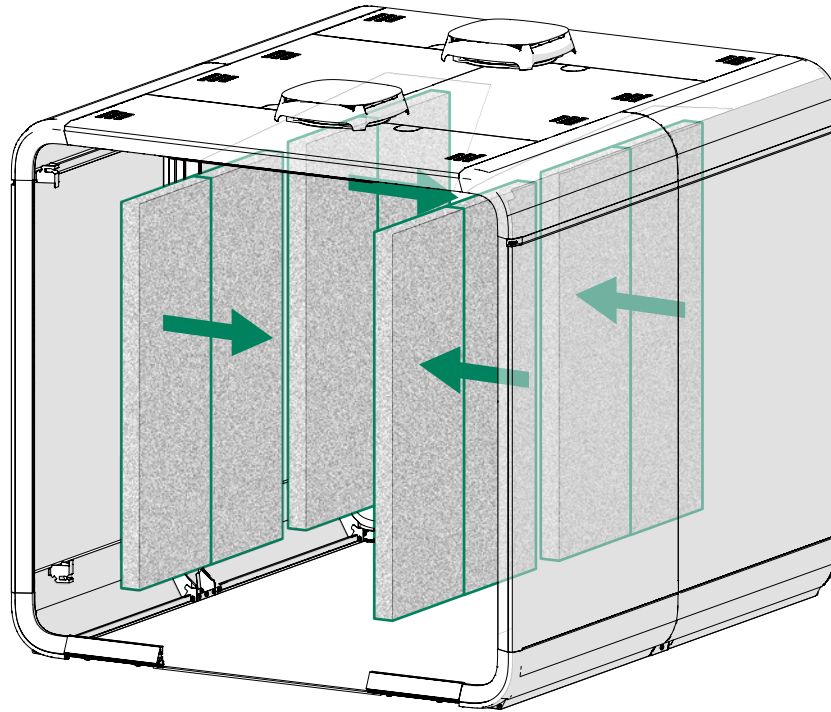

12.  **Note:** Coat hook is an option.

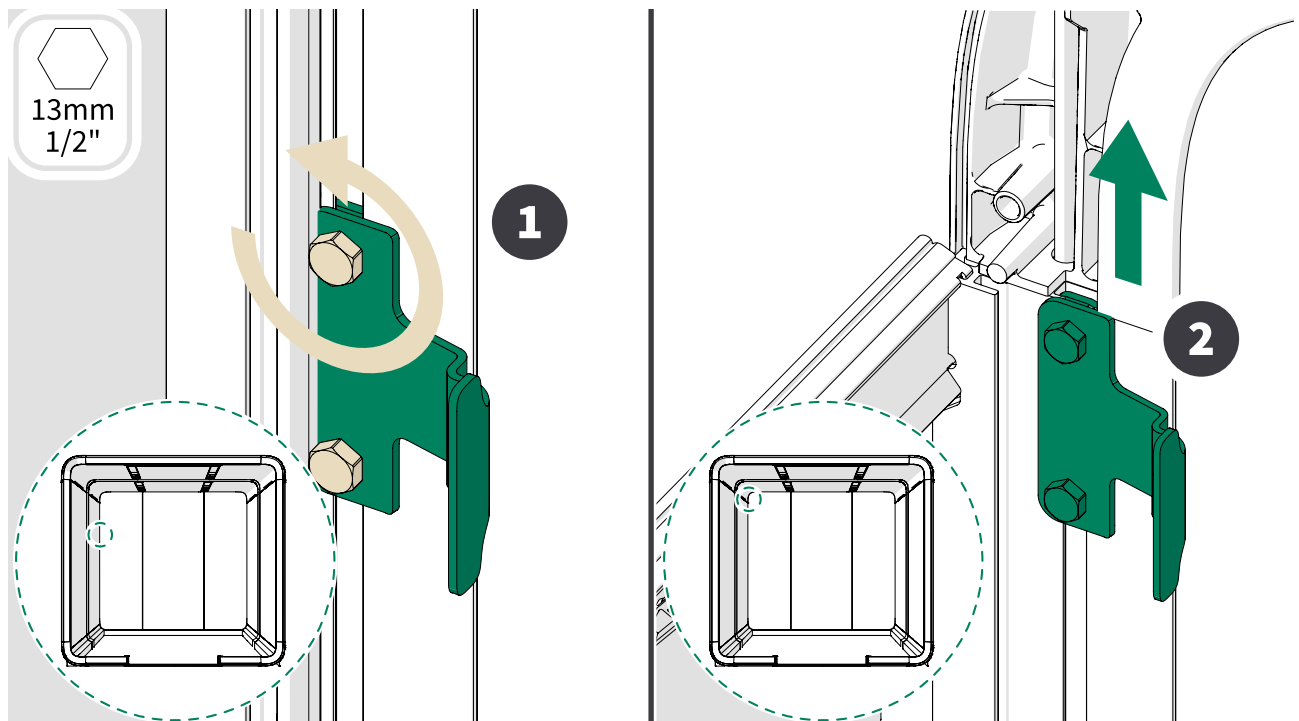

13.  **Warning:** Work on and finish one corner at a time. Do not unscrew more than one corner at a time.

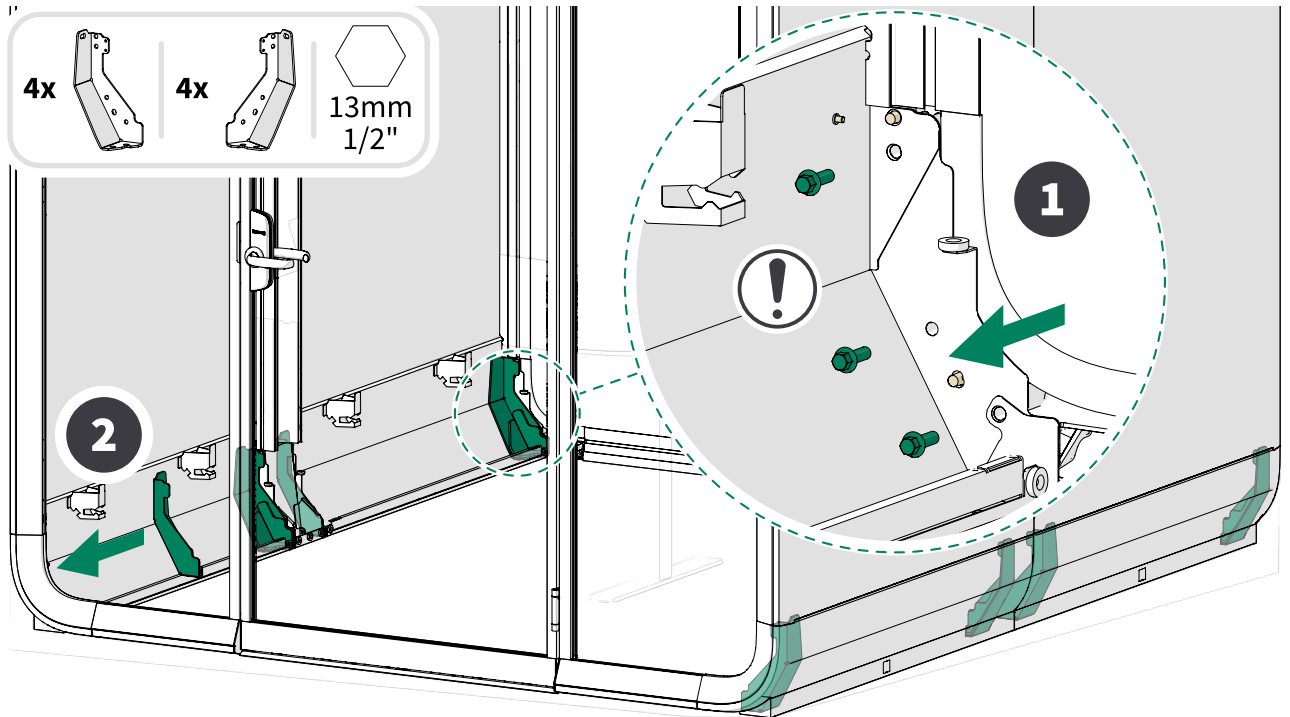

14.

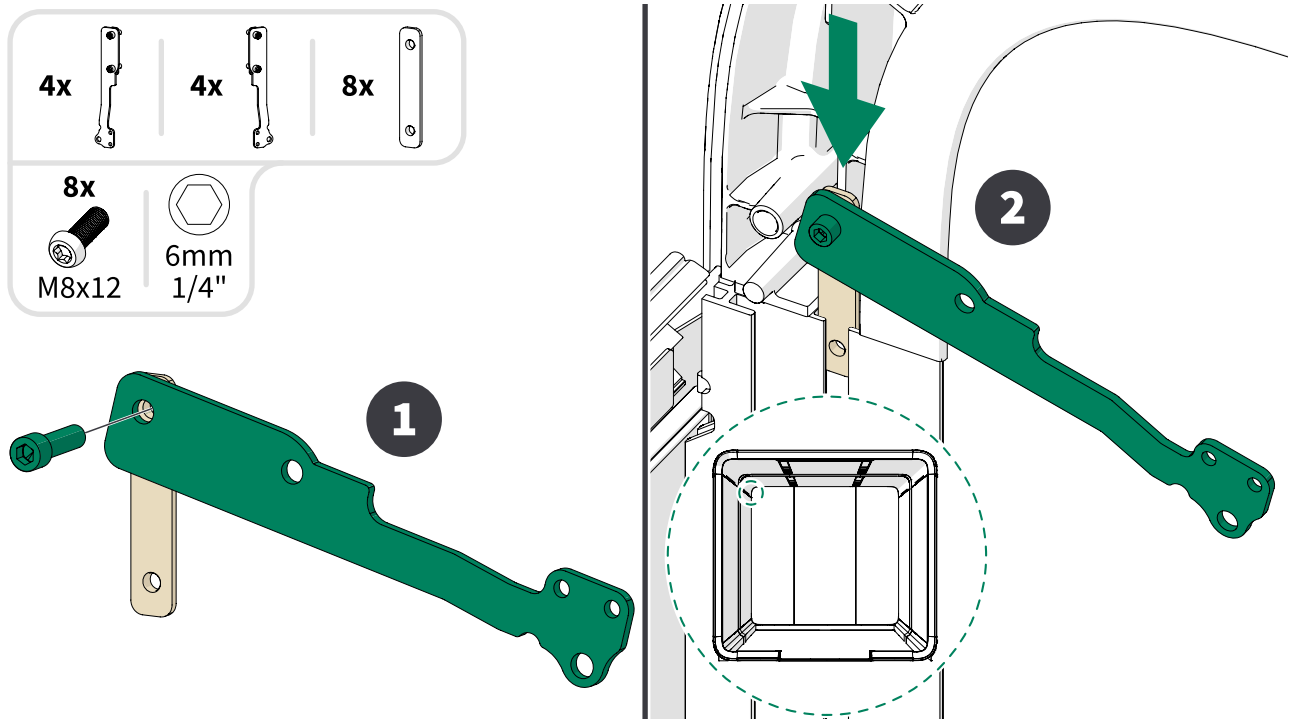

15.

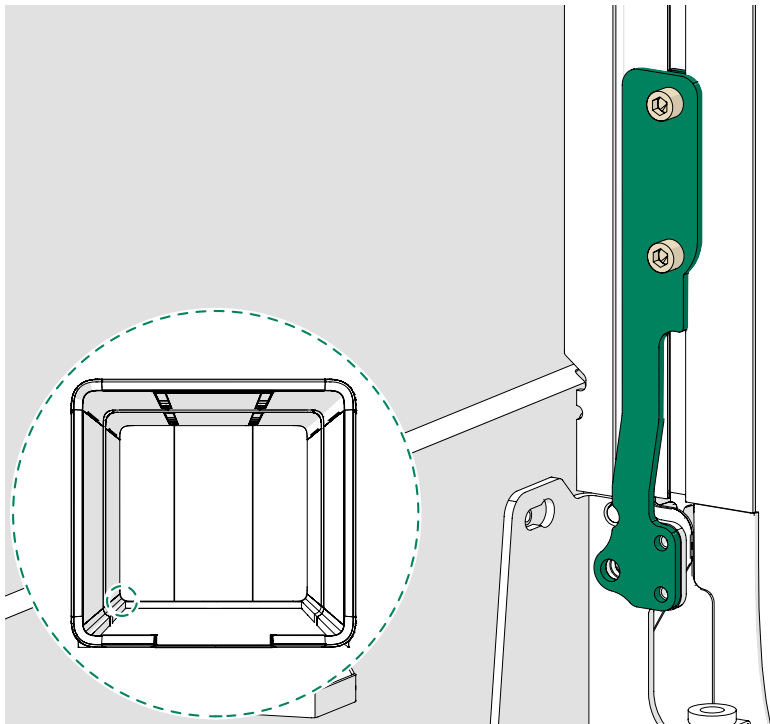

16.

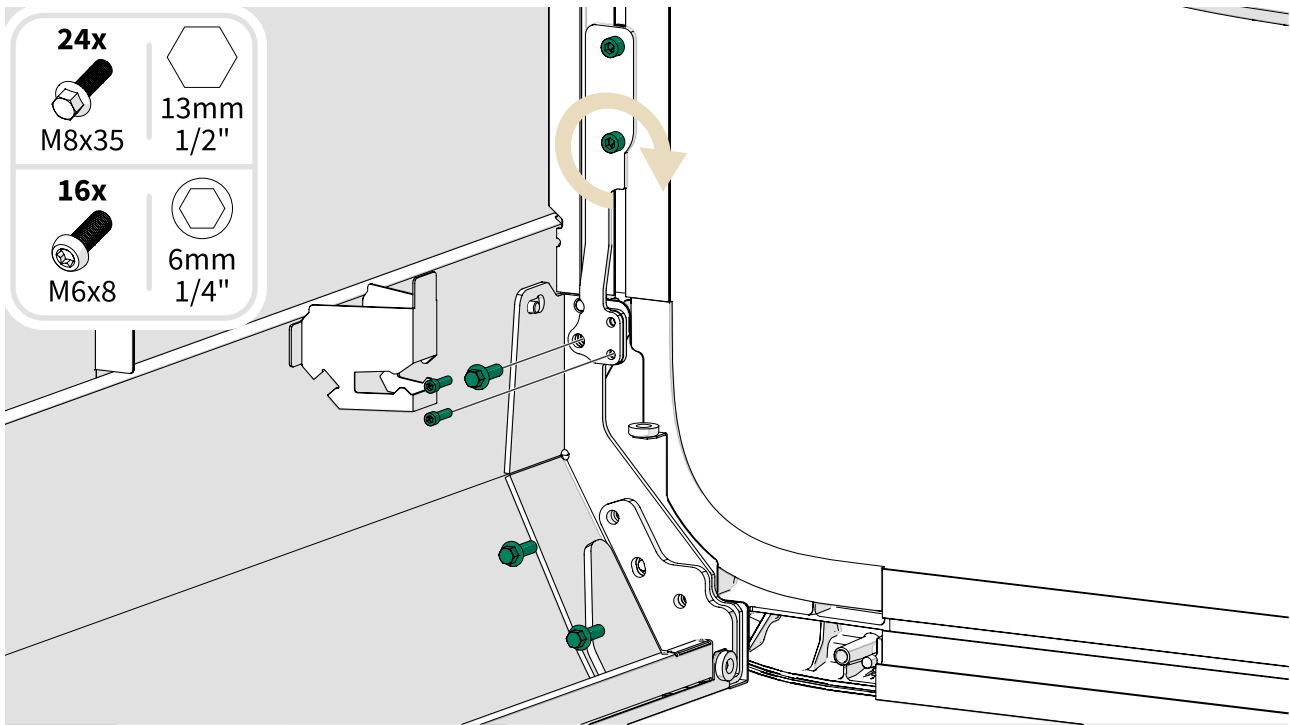

17. Drill holes for the anchors.

Verify the required hole depth with anchor guidelines.

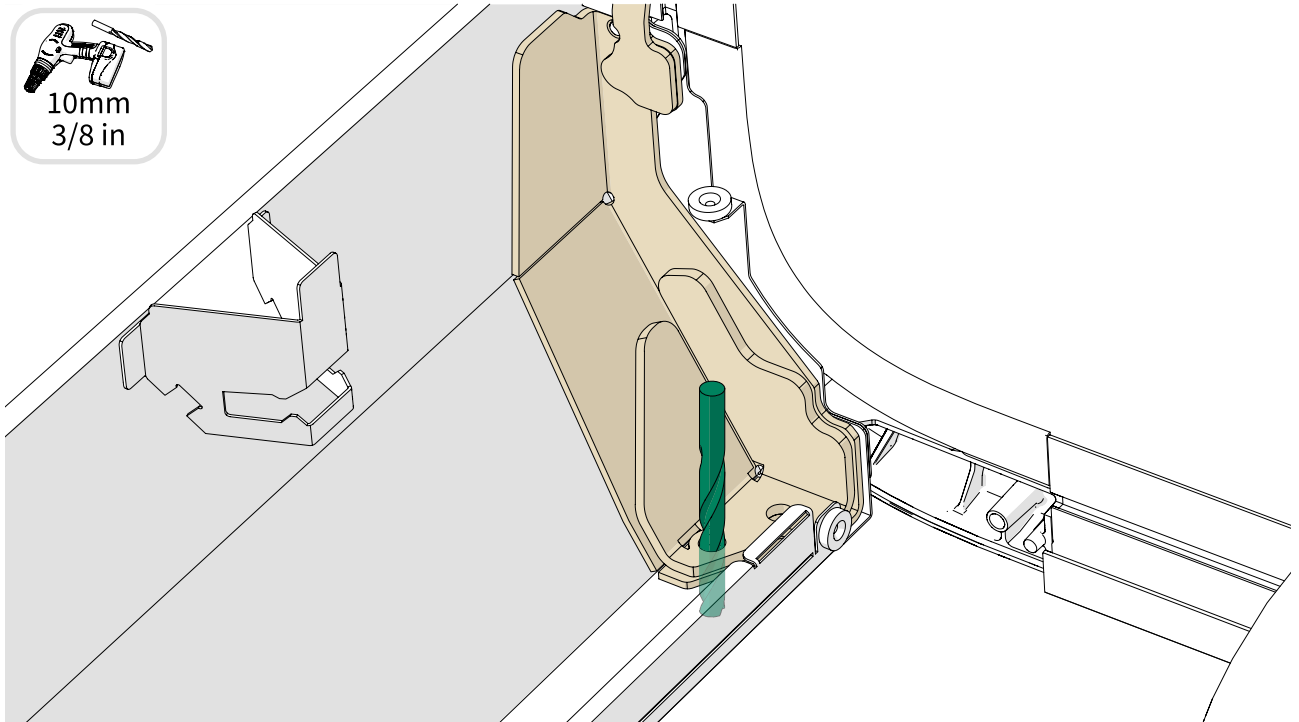

Note: Drill bit size is based on the anchor selected.

**18. Clean the drilled holes according to anchor guidelines.****19. Install the anchors.**

The thickness of the seismic anchoring brackets is 0.7 in (17.8 mm). The hole diameter in the brackets is 0.55 in (13 mm)



Note: You can use either of the two holes. (Wood floors may require both holes to be used.)



Note: The anchors are not included.

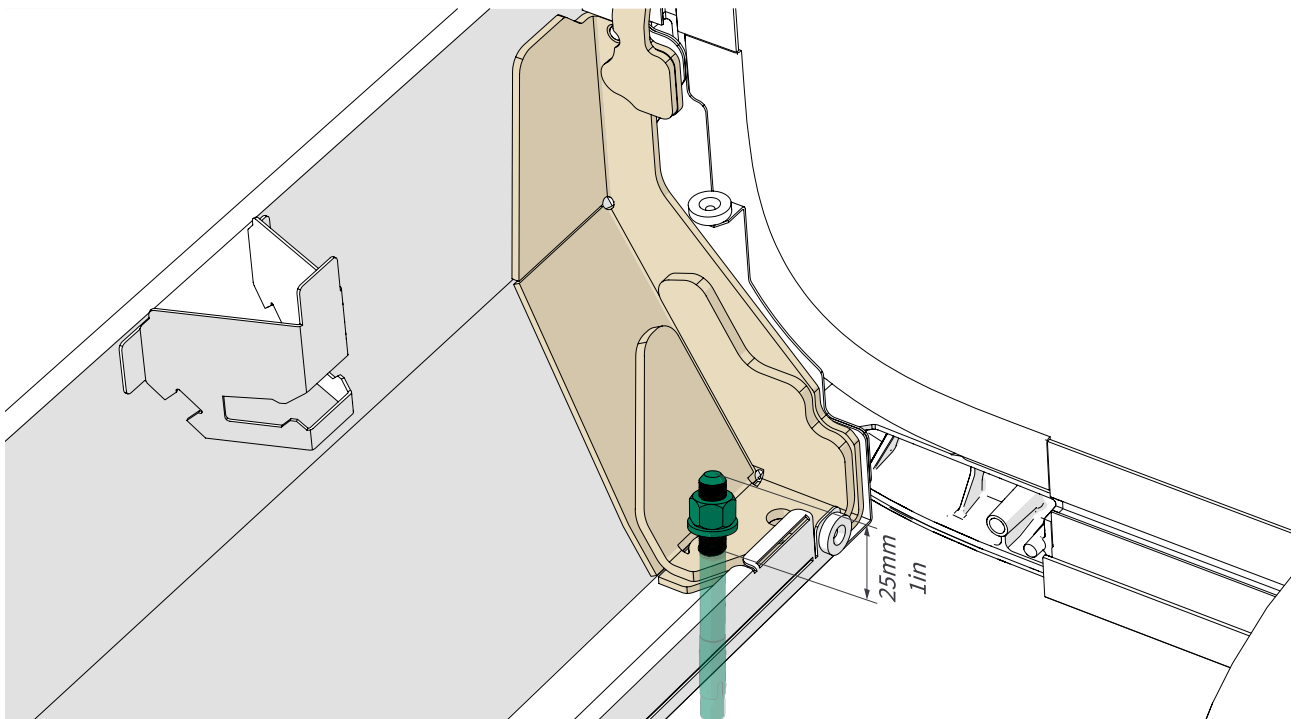

20. The anchors should be torqued to bolt manufacturer's guidelines. It is important to check both the bolt manufacturer's literature and the Professional Engineering calculations for this project.
21.  **Note:** Coat hook is an option.

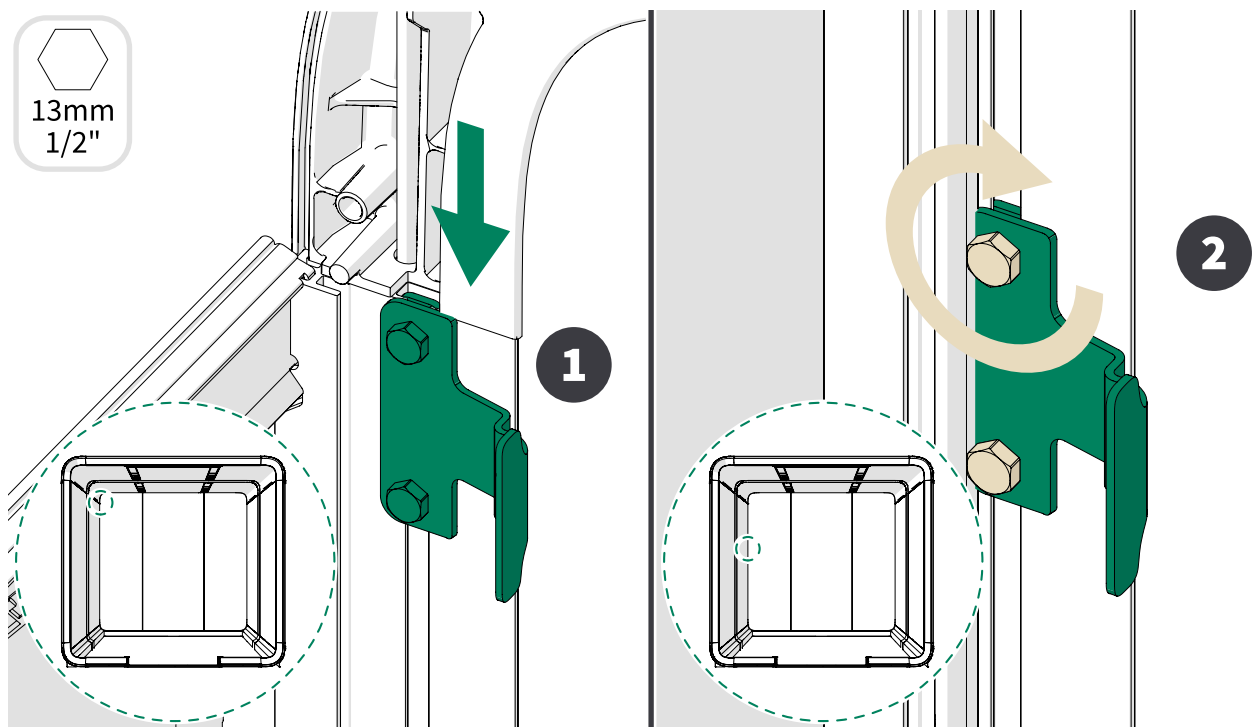

22.

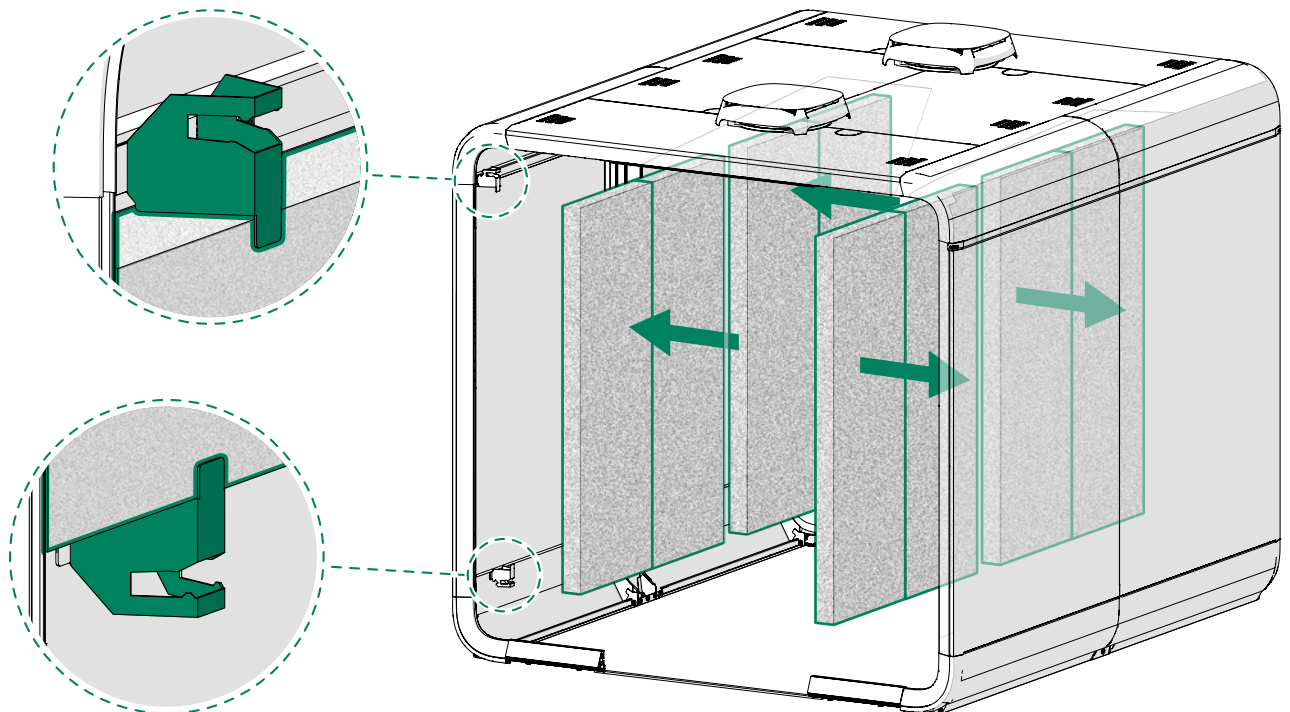

23.

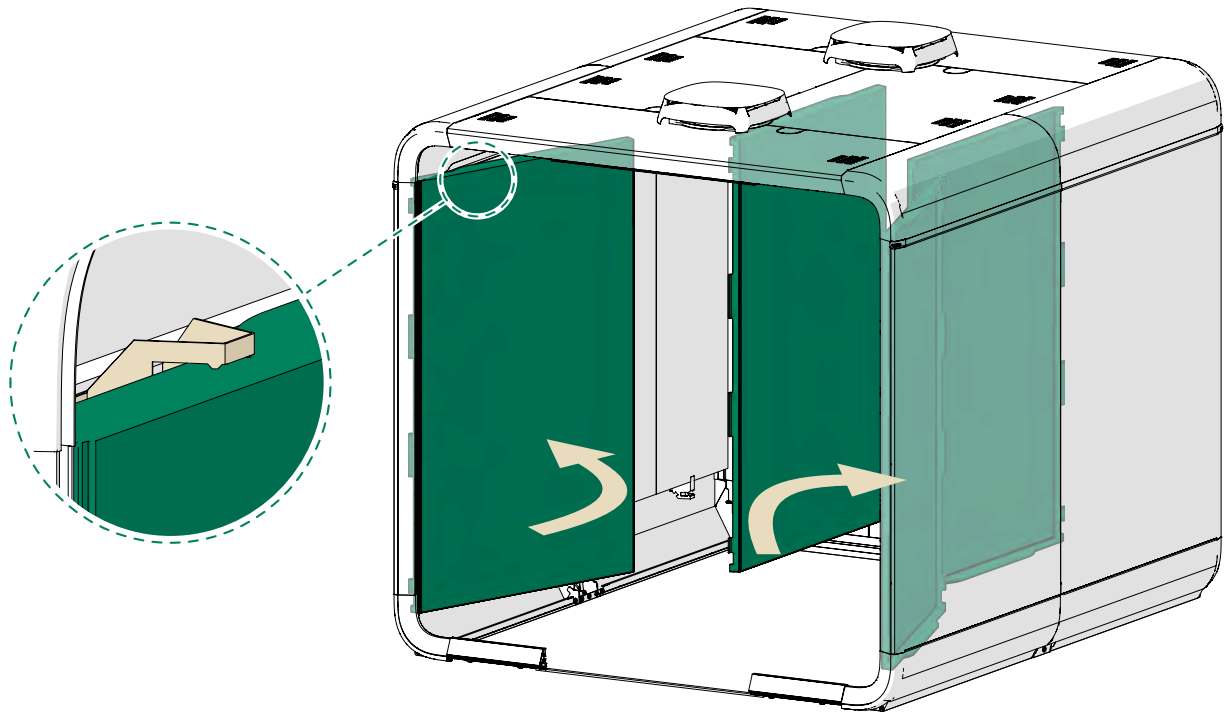

24.

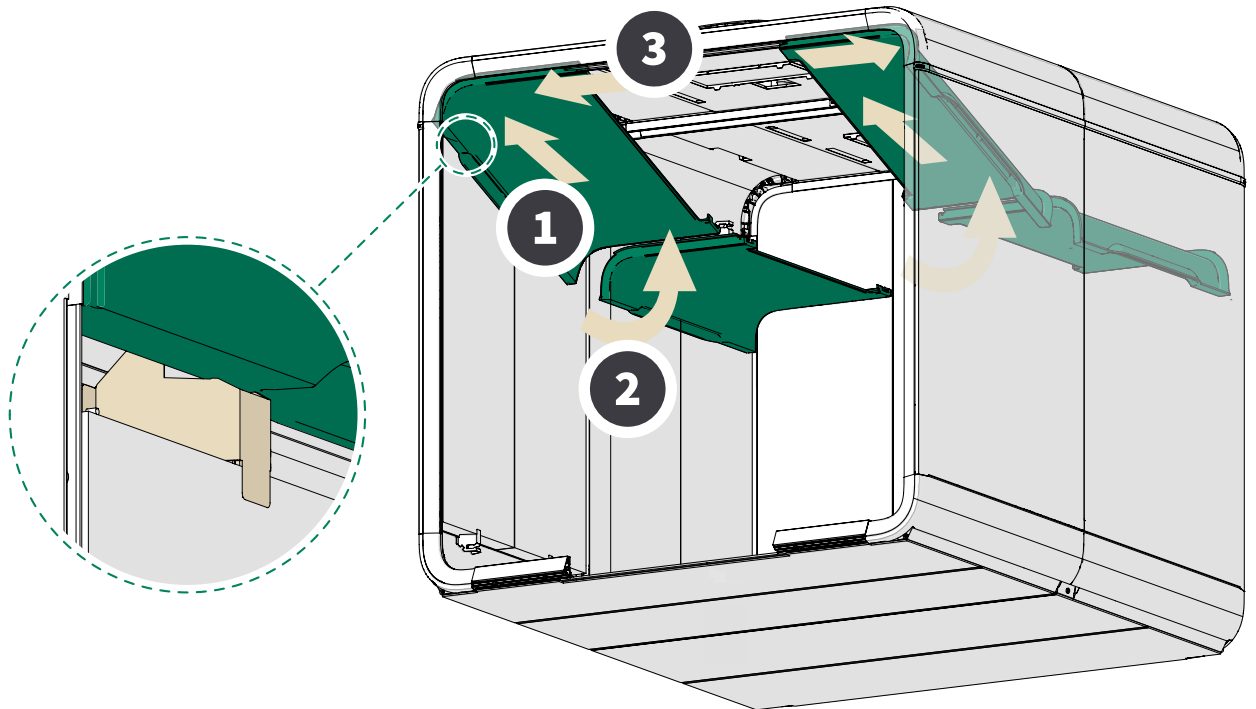

25.

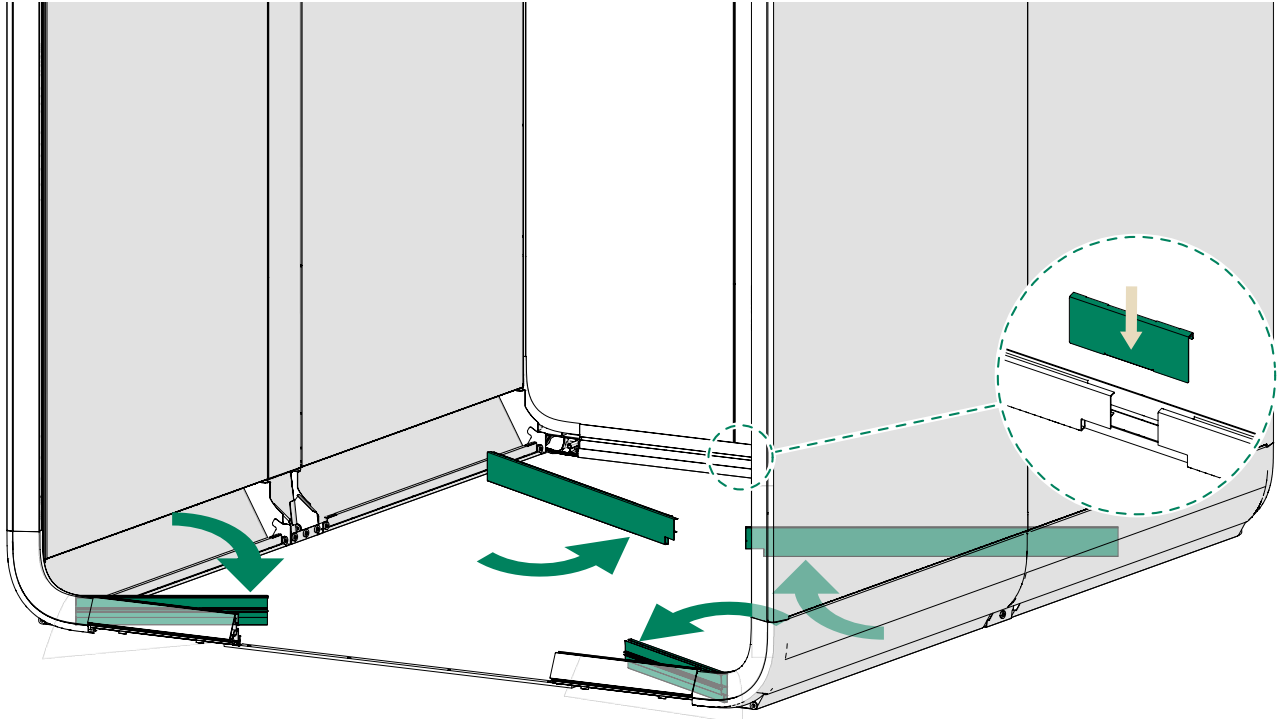

26.

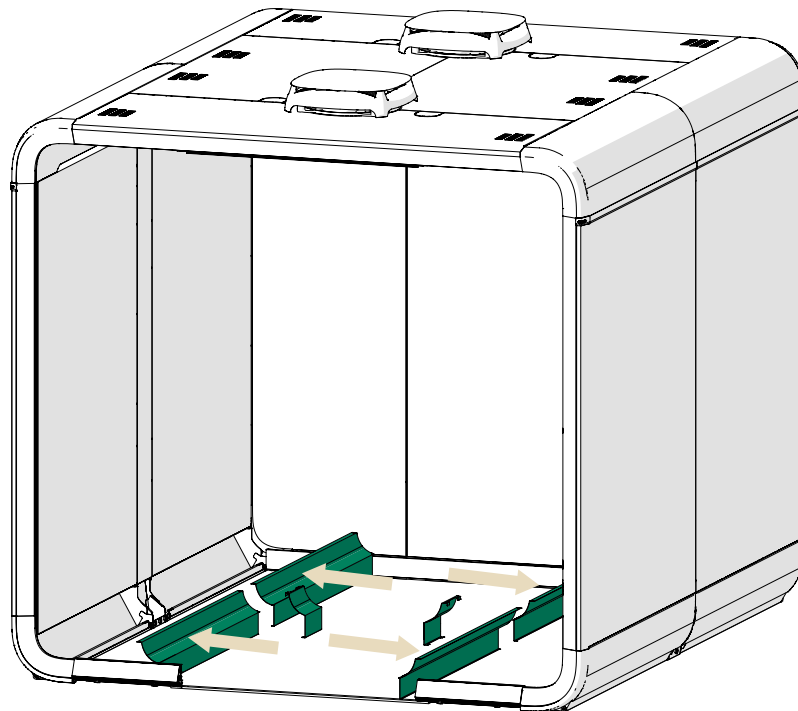

27.

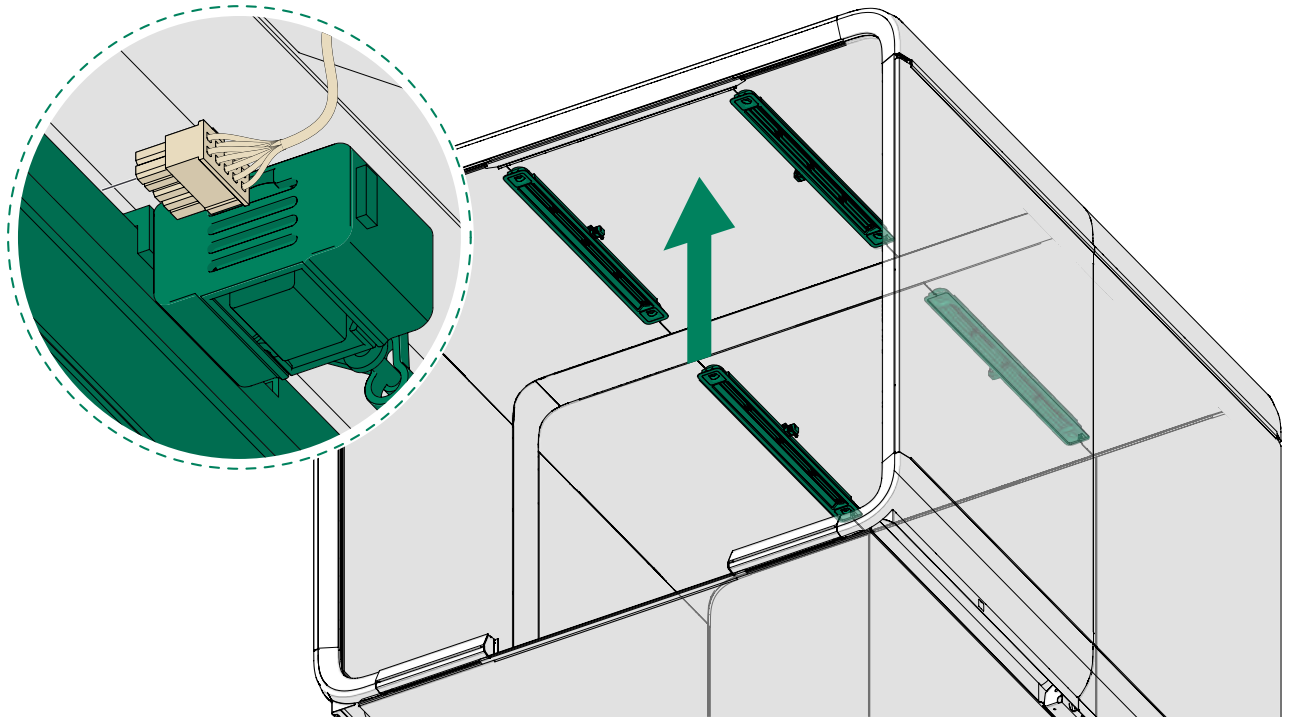

28.

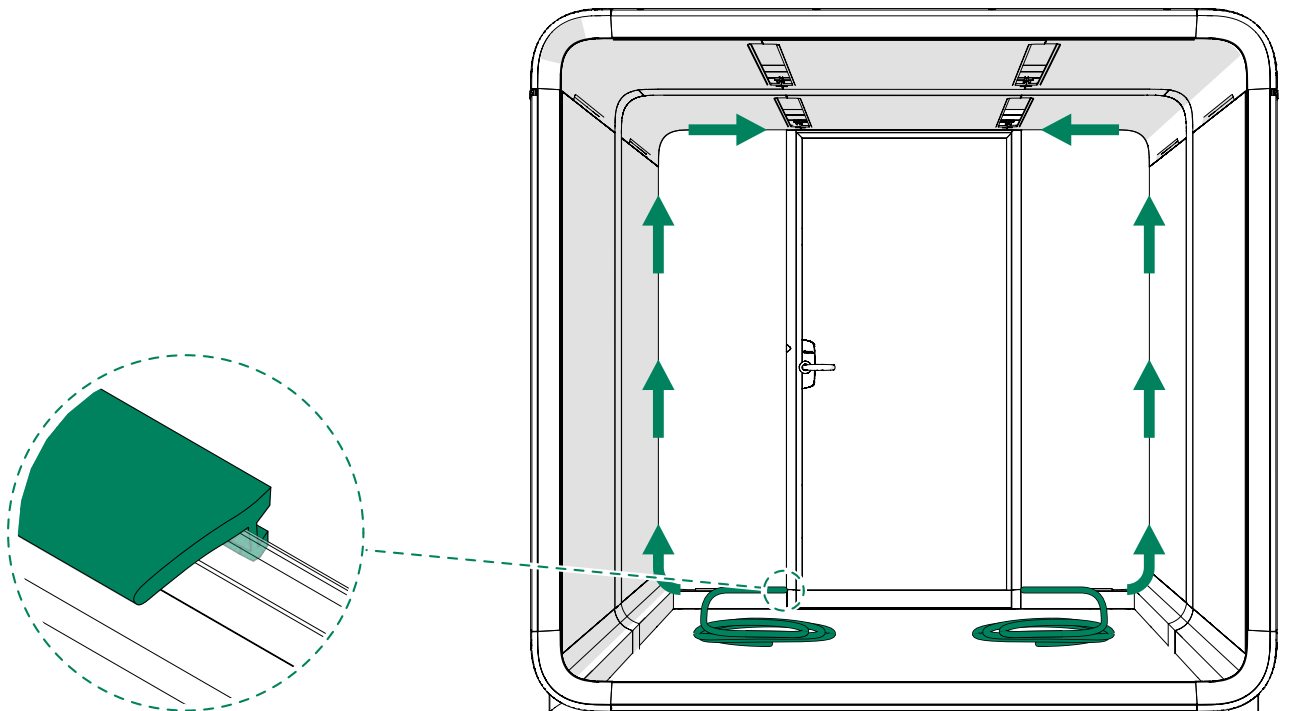

29.

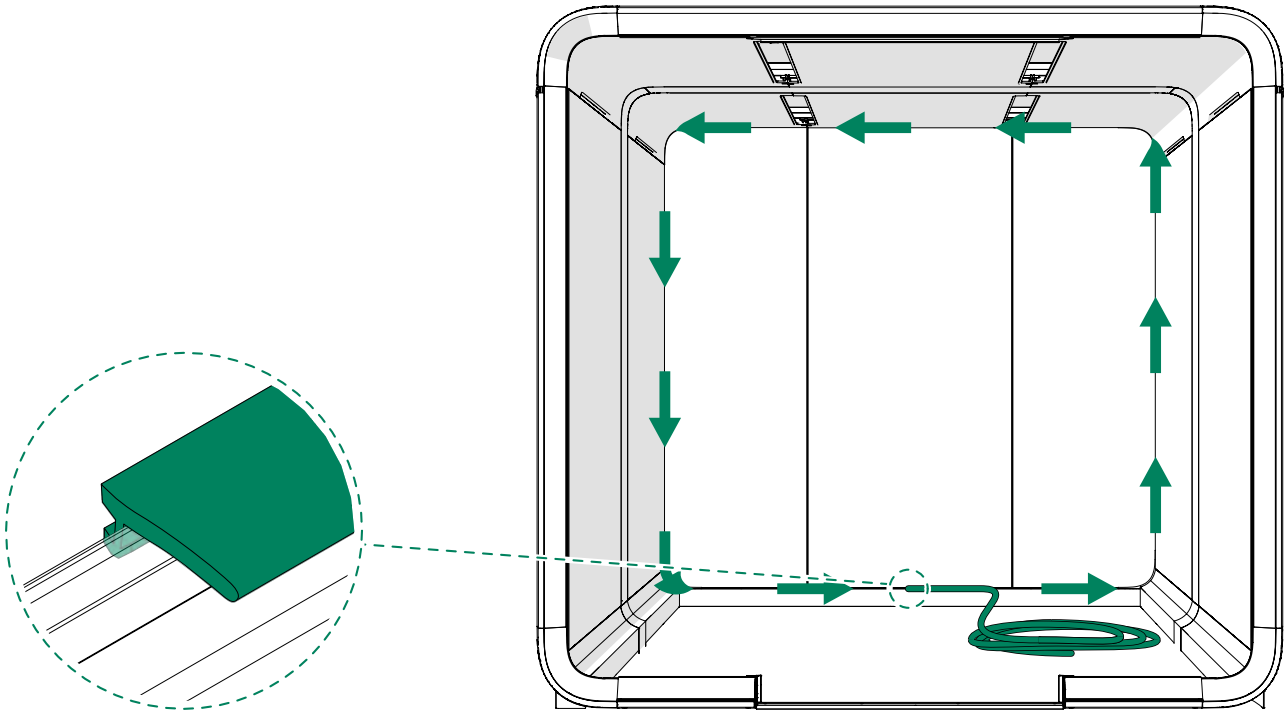

30.

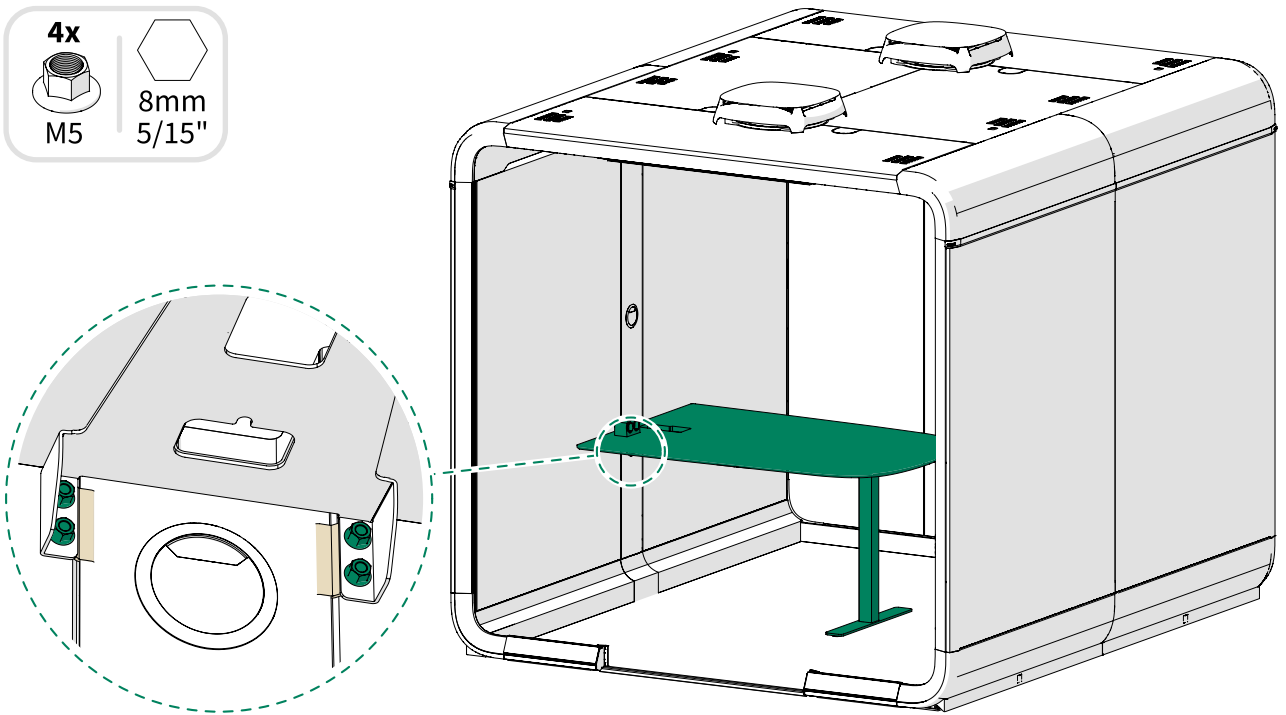

31.

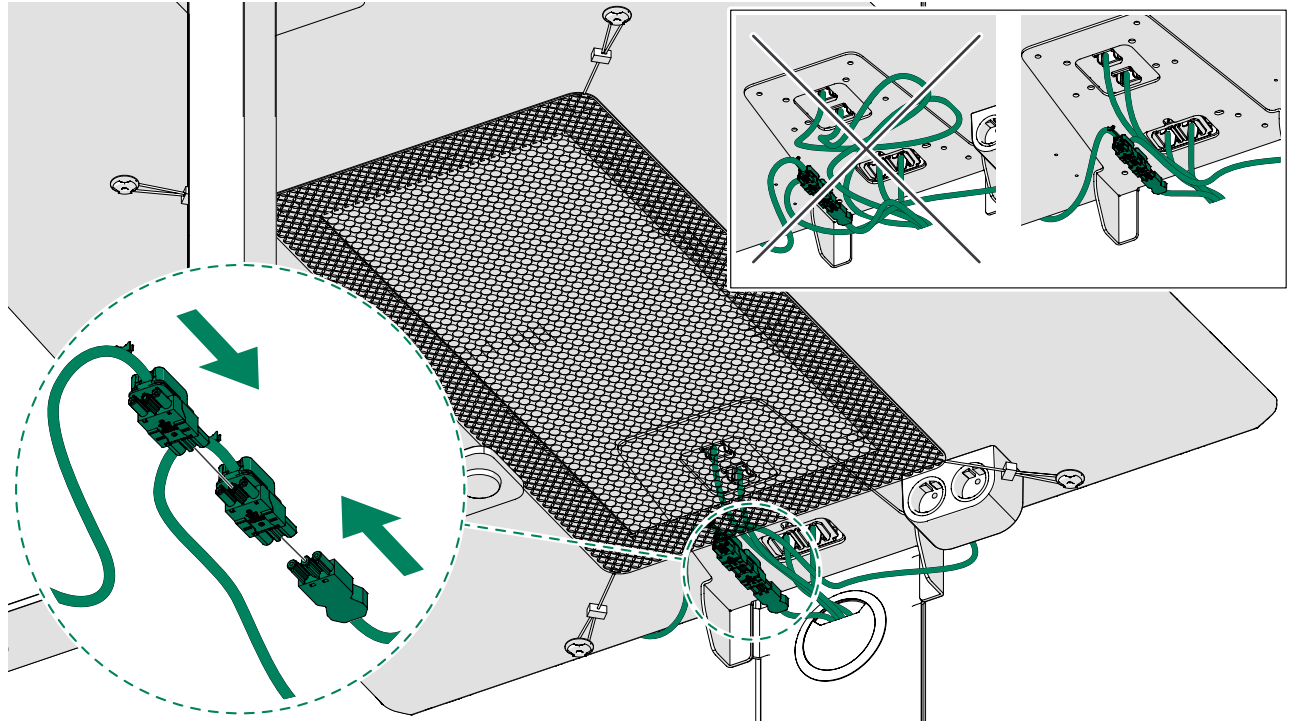

32.



Note: Whiteboard is an option.

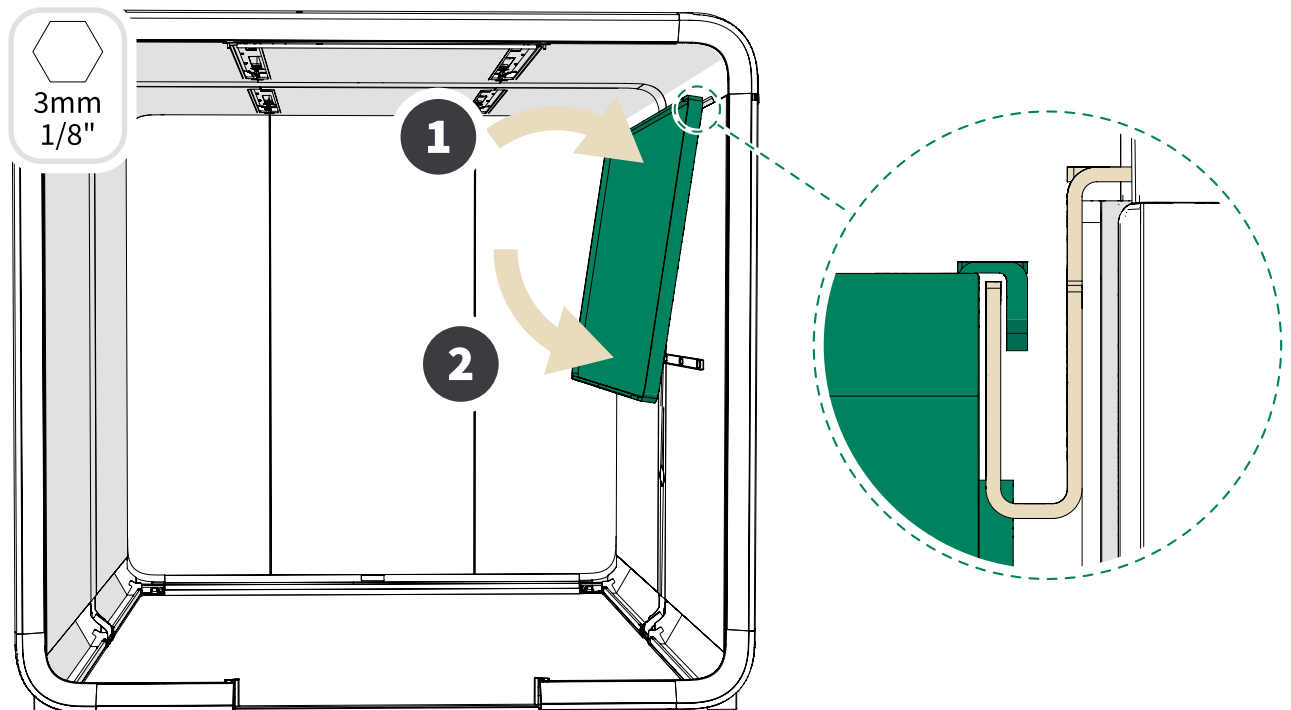

framery

Framery Six
Seismic kit installation instructions
Patamäenkatu 7
33900 Tampere
FINLAND
VAT: FI 23527139