

Framery One Compact

Seismic kit installation instructions

English  
Version 1.2

Tampere, Finland 29.10.2024



# Contents

- 1 Important safety and product instructions..... 5**
  - 1.1 Preface.....5
  - 1.2 Product information..... 5
  - 1.3 Copyright.....5
  - 1.4 Manual contents..... 5
- 2 Seismic anchoring requirements..... 6**
- 3 Install the frames..... 7**
- 4 Install the kickboards.....12**



# 1 Important safety and product instructions

## 1.1 Preface

This instruction manual describes the installation of the product. Everyone involved in installing the product must read and understand the contents of the installation and safety instructions.

This instruction manual gives you necessary information for the correct installation of the product.

For complete product and safety instructions, see **help.framery.com**.

## 1.2 Product information

The information in this manual corresponds to the product at the time of delivery. All information included in this manual is valid at the time of publication.

## 1.3 Copyright

This document must not be copied, presented, or delivered to a third party without explicit permission from Framery. The use of this document for any purpose other than those allowed by Framery is prohibited. Framery reserves the right to change the instructions related to the product without separate notice.

## 1.4 Manual contents

The installation instructions contain the following information:

- General information about the purpose and content of the instructions
- Information related to safety
- Installation instructions

## 2 Seismic anchoring requirements

**Note:** When installing the product, take into consideration all local laws, rules and regulations concerning seismic anchoring and seismic safety.

For installations in the U.S., in buildings located in Seismic Design Categories A and B, anchoring to the floor is optional. In buildings located in Seismic Design Categories C, D, E or F, anchoring to the floor is required.

When anchoring to the floor, plans that address seismic design categories must be prepared by a registered design professional. The plans are to include definitions on the type, size and location of anchors and installation limitations. Additionally, installation must be in accordance with the applicable codes [IBC, IFC, IMC, NFPA 70 and, when installed with a sprinkler, NFPA 13].

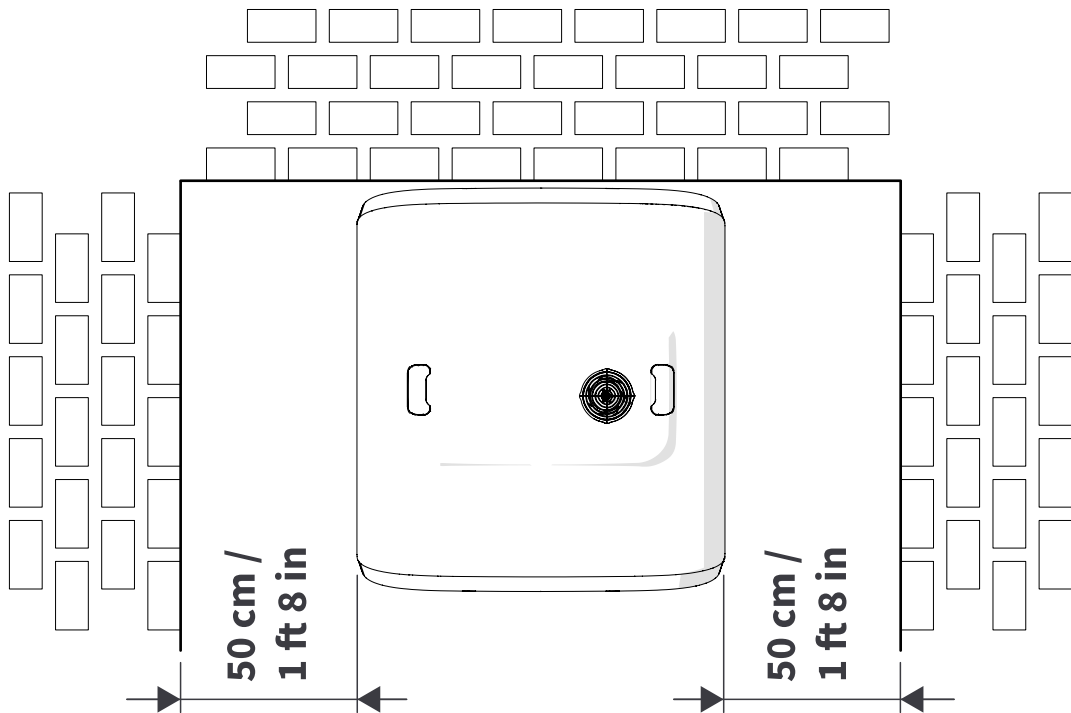

**Figure 1: Required operating space when installing seismic anchoring**

### 3 Install the frames

1.

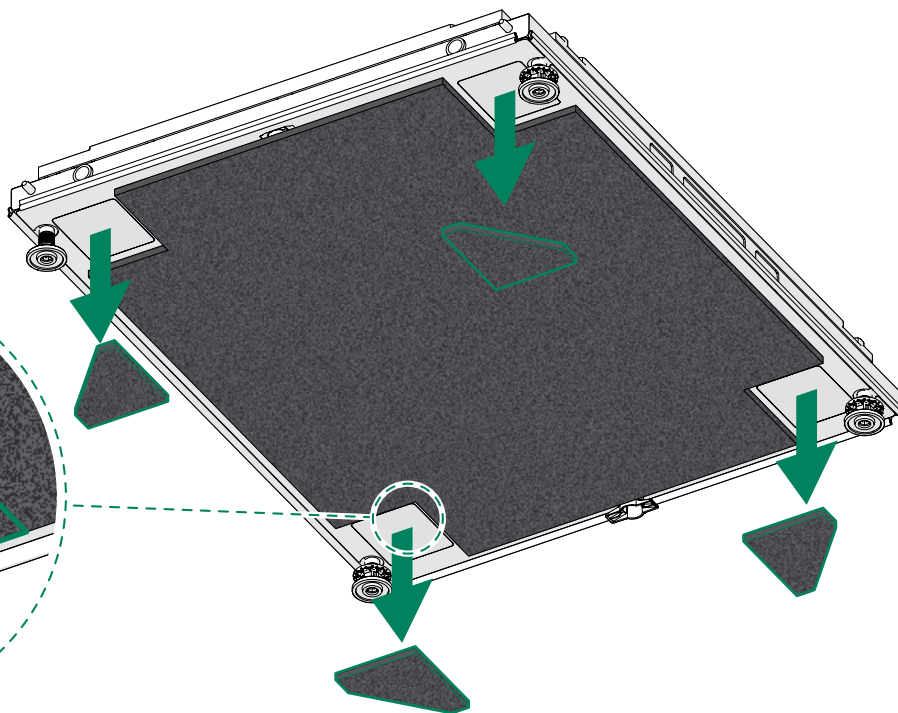
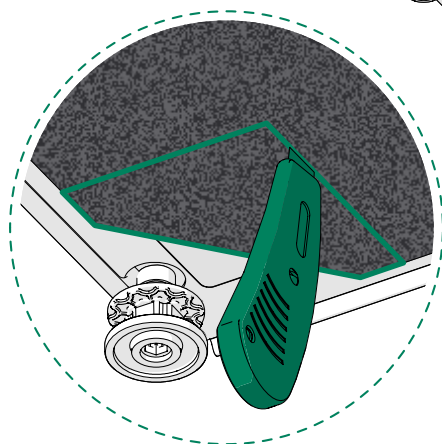



2.

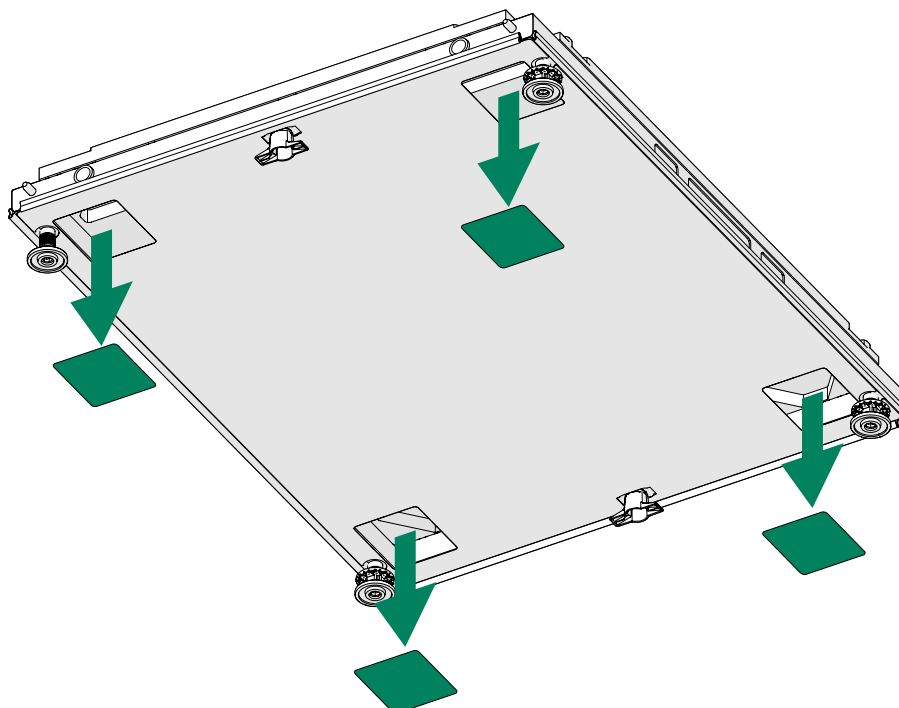

**Note:** Hit the bottom plates gently with a hammer to remove them.



3.  **Note:** Align the holes on the floor support with the holes on the side of the floor module.
-  **Note:** Insert bolts only partially through the holes.

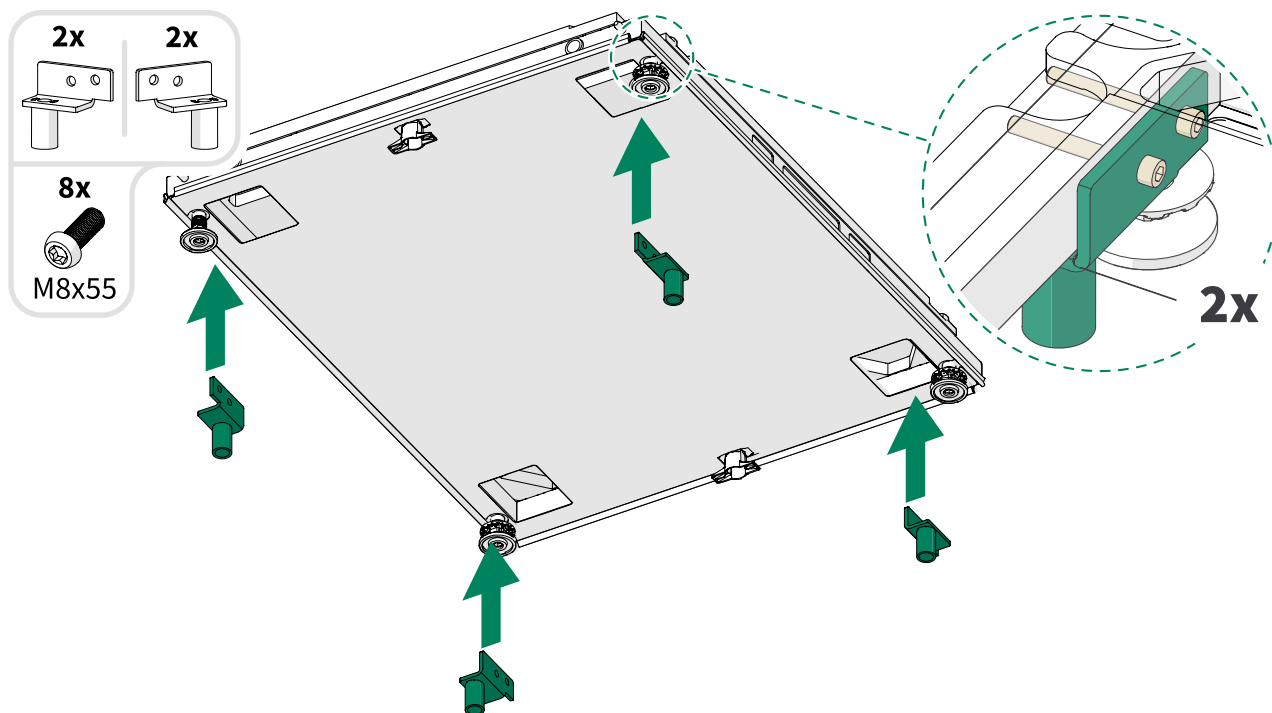

4.  **Note:** Do not tighten the nuts completely. Keeping them slightly loose at this point makes aligning the screws to the frame easier later.

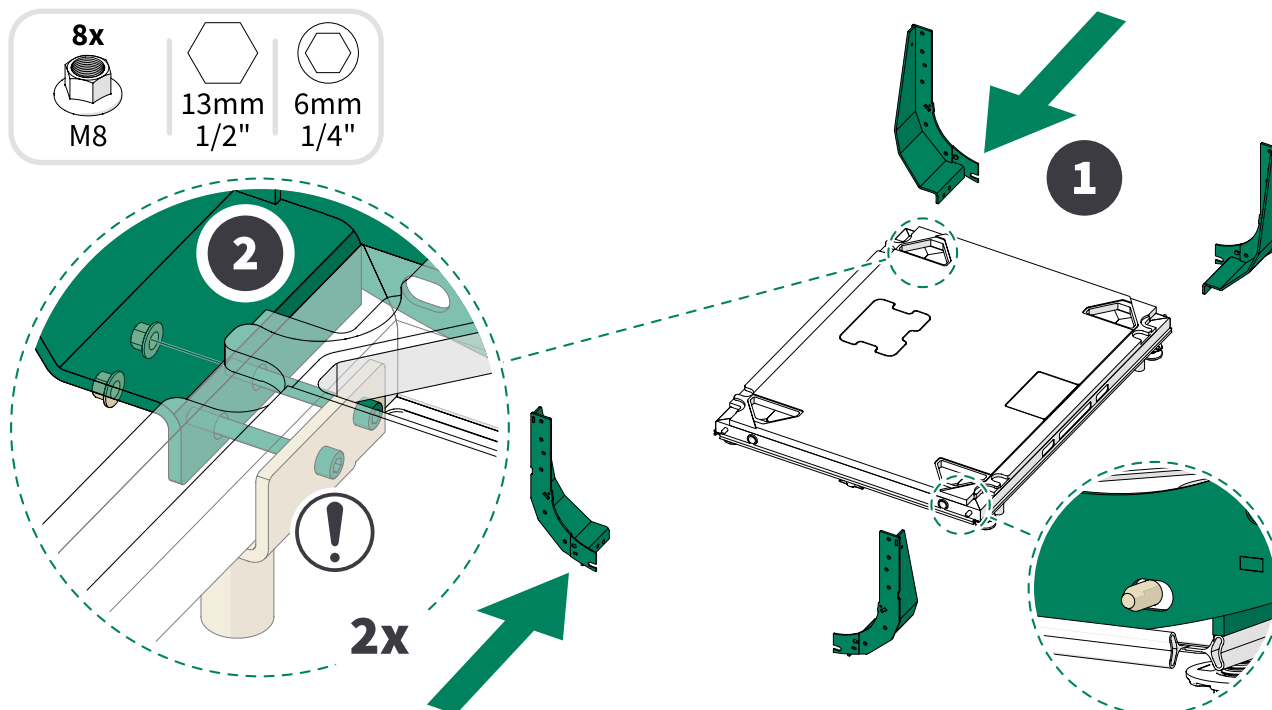



5.  **Warning:** Hold the door frame upright while another installation technician secures it to the floor module.

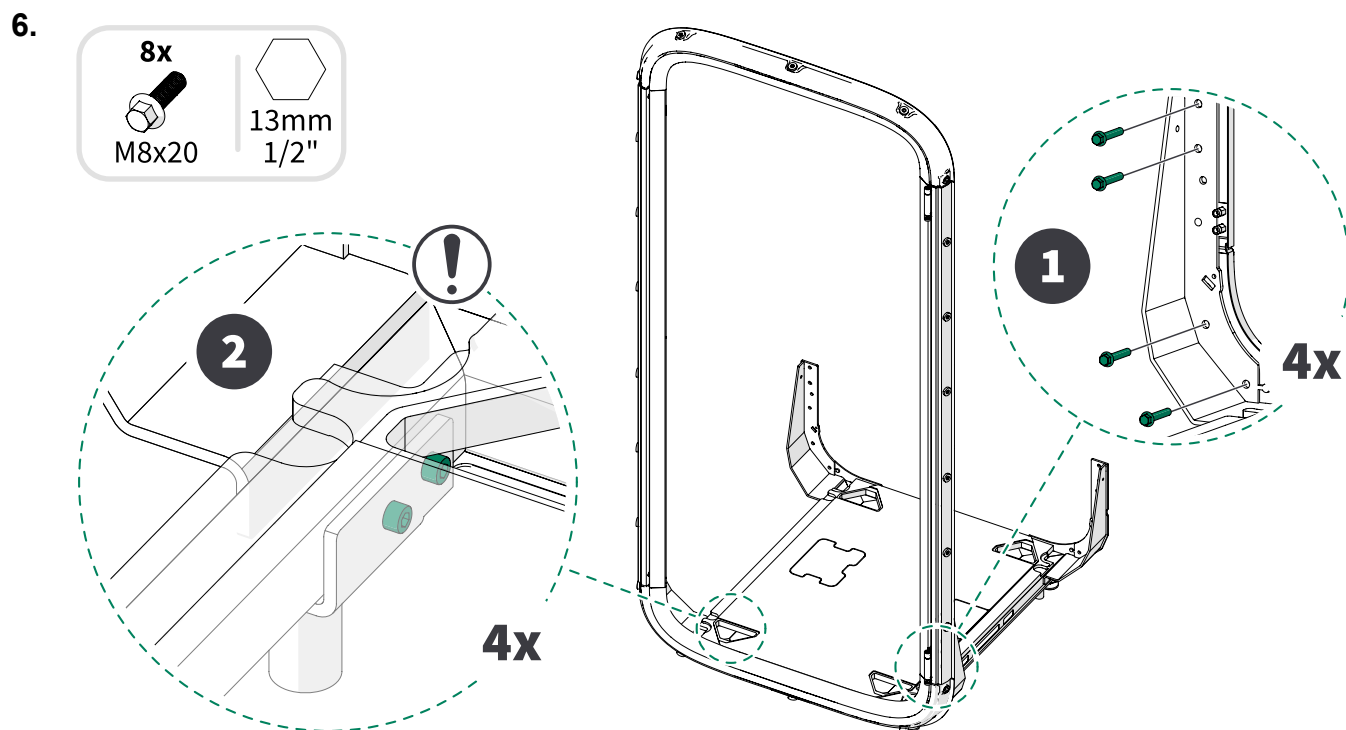
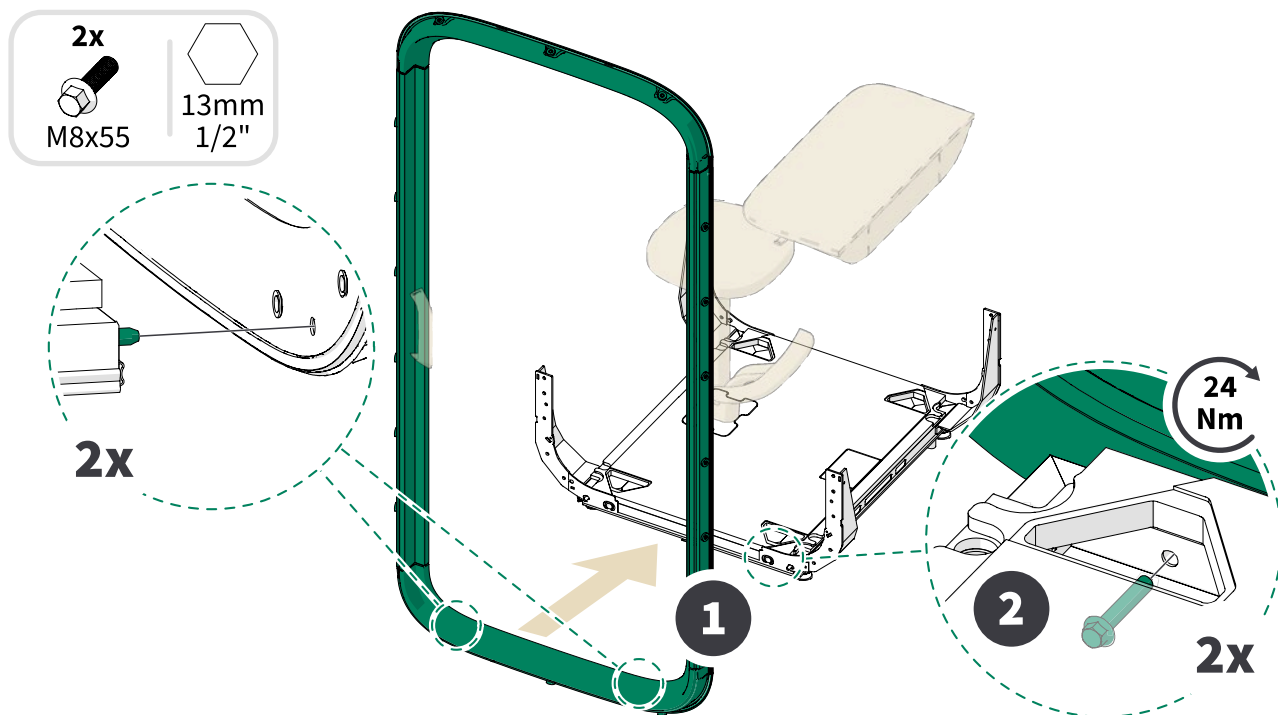

7.



**Warning:** When the door frame and glass wall are installed to the floor module, the structure is unstable until the frames are connected. Hold the glass wall upright until another installation technician installs a support beam between the frames.

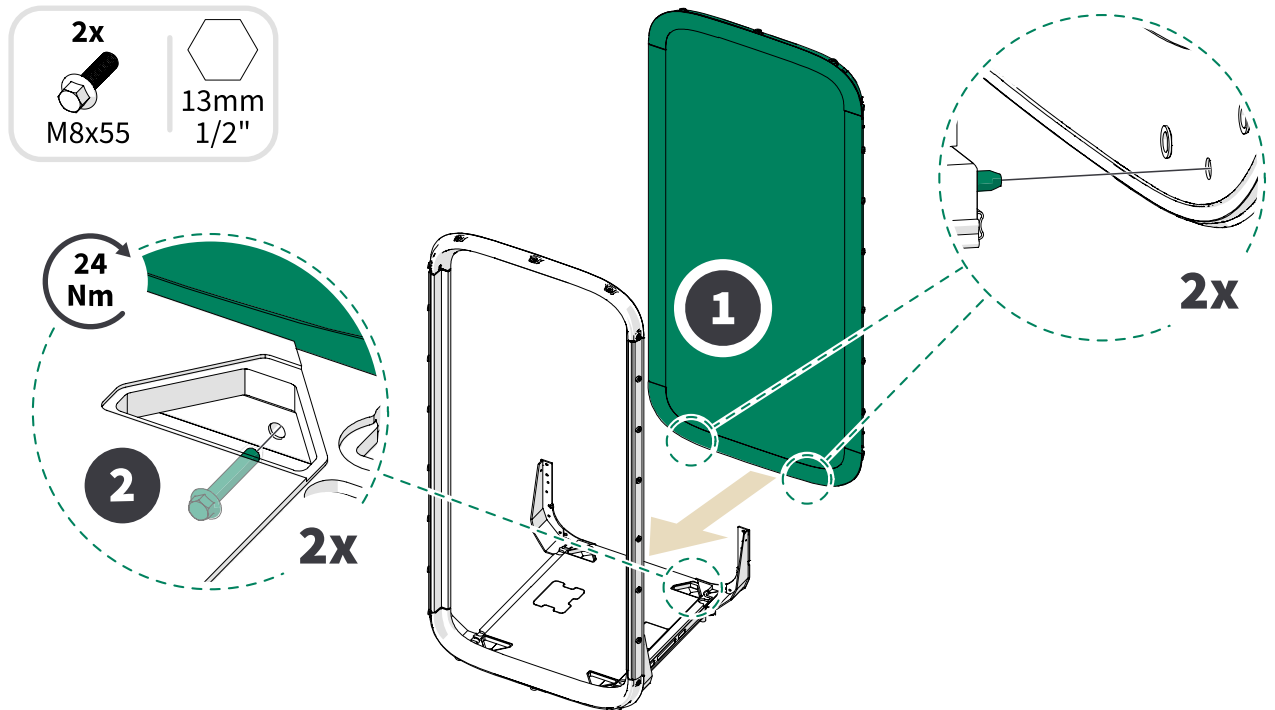

8.

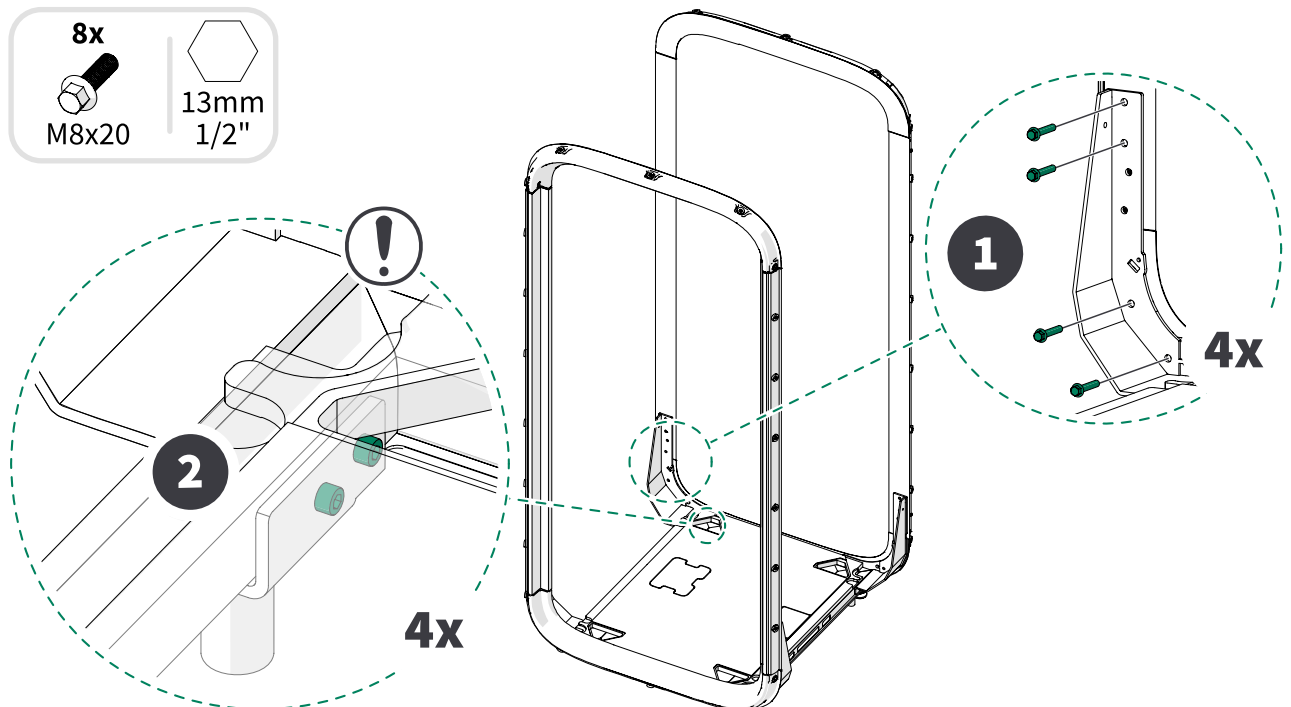

9.

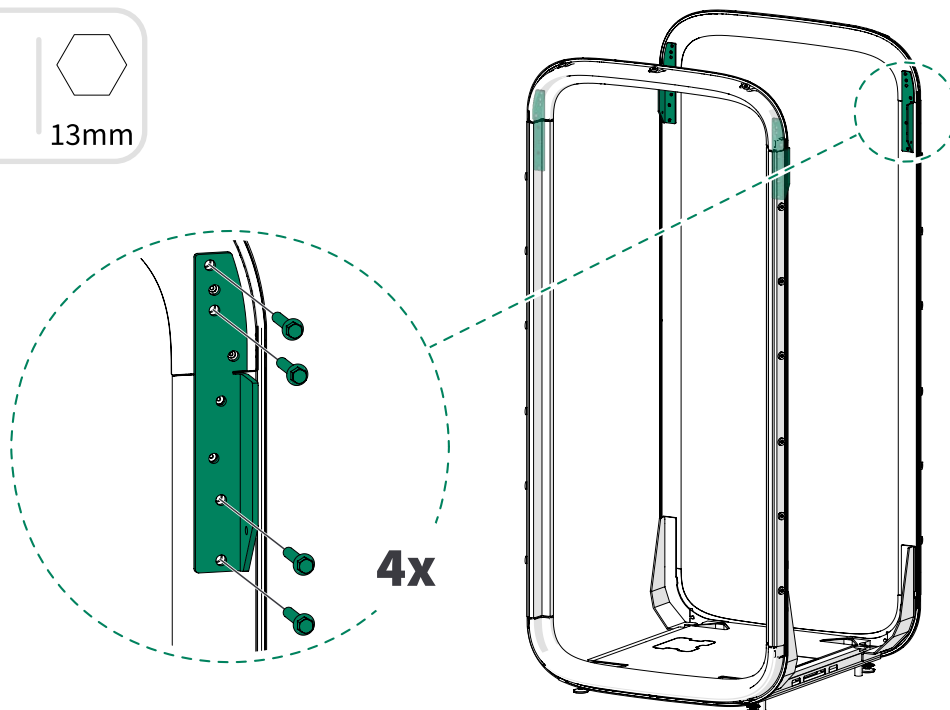
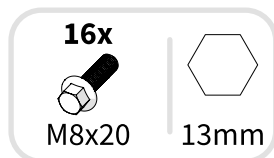

10.



**Note:** When attaching the table wall support to the frames, be careful not to bend the hook on the support.

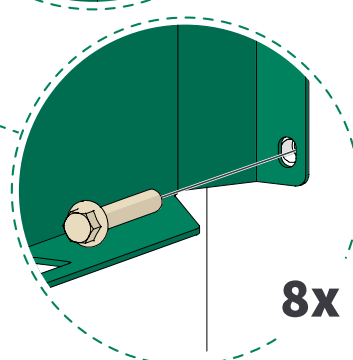
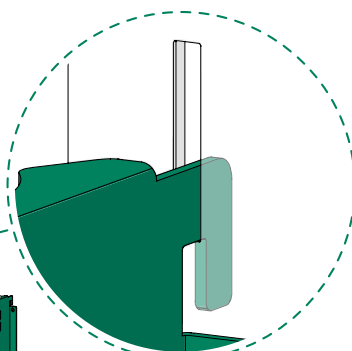
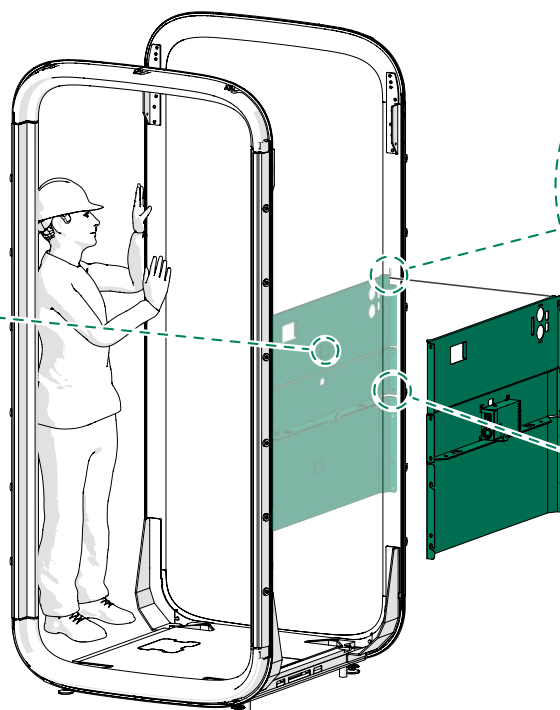
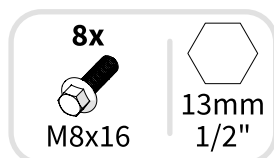

## 4 Install the kickboards

1.  **Note:** Do the following steps on both sides of the pod.

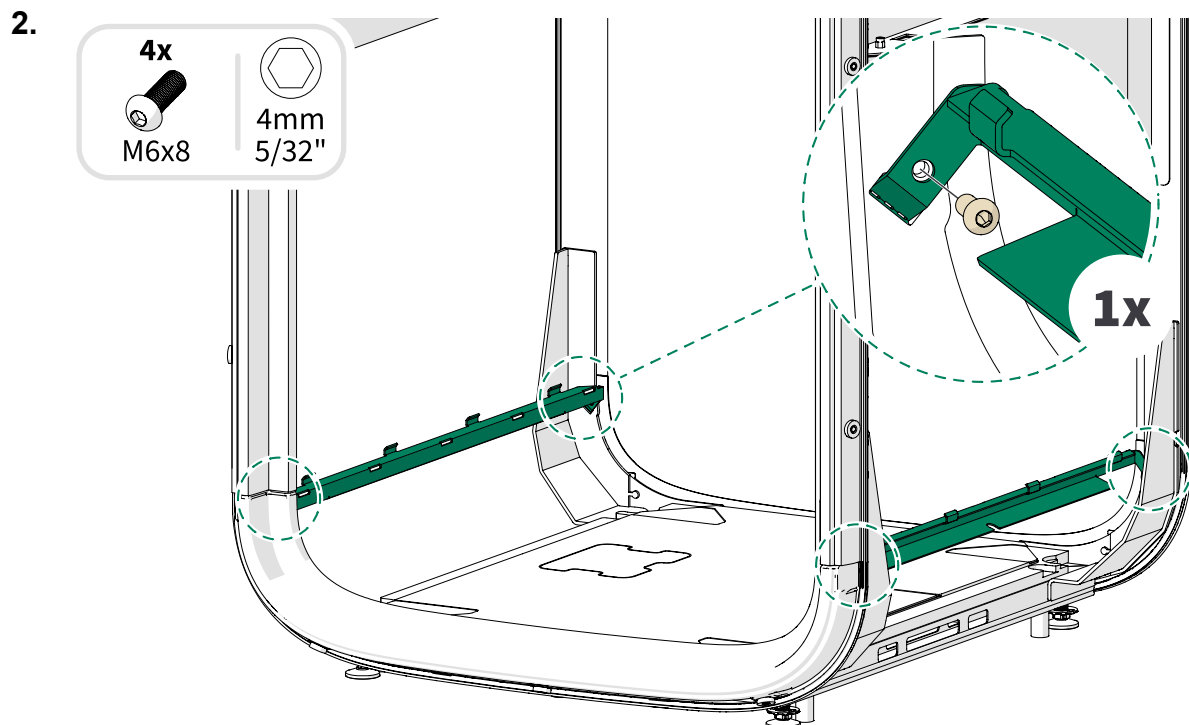
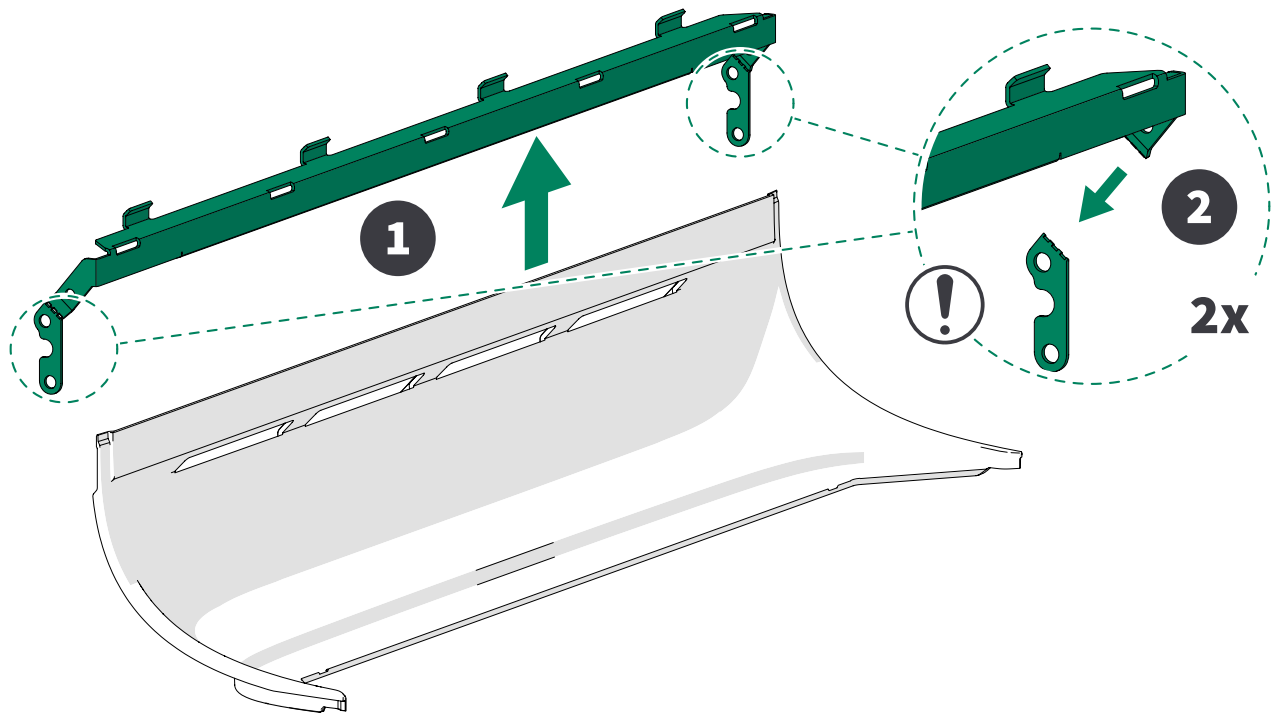

3.

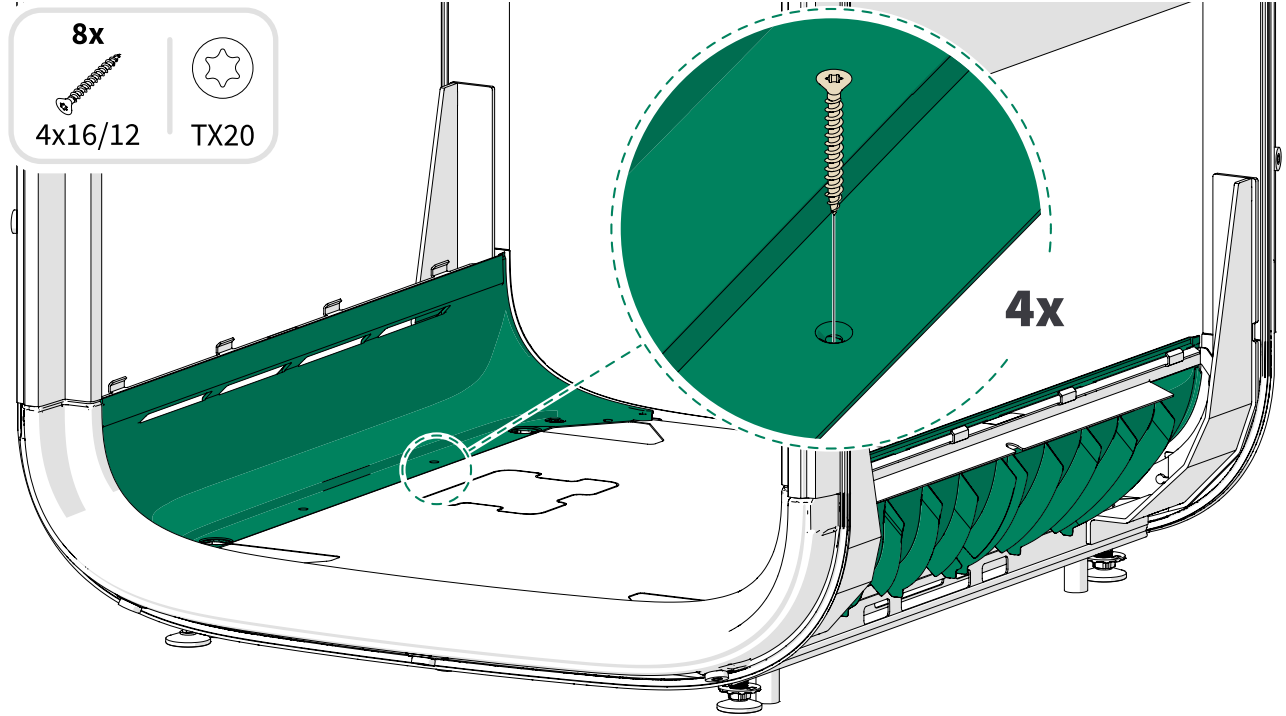





**framery**

Framery One Compact  
Seismic kit installation instructions  
Patamäenkatu 7  
33900 Tampere  
FINLAND  
VAT: FI 23527139