

Exterior tablet mount
Installation instructions

English
Version 1.0
Tampere, Finland 18.03.2025

Contents

1 Install the exterior tablet mount.....5

1 Install the exterior tablet mount

⚠ **Note:** A 3 m USB-C cord is needed for powering the tablet. The tablet and cord for powering the tablet are not included in the package.

1. Choose the small or large wooden back plate according to the size of the customer supplied tablet holder.

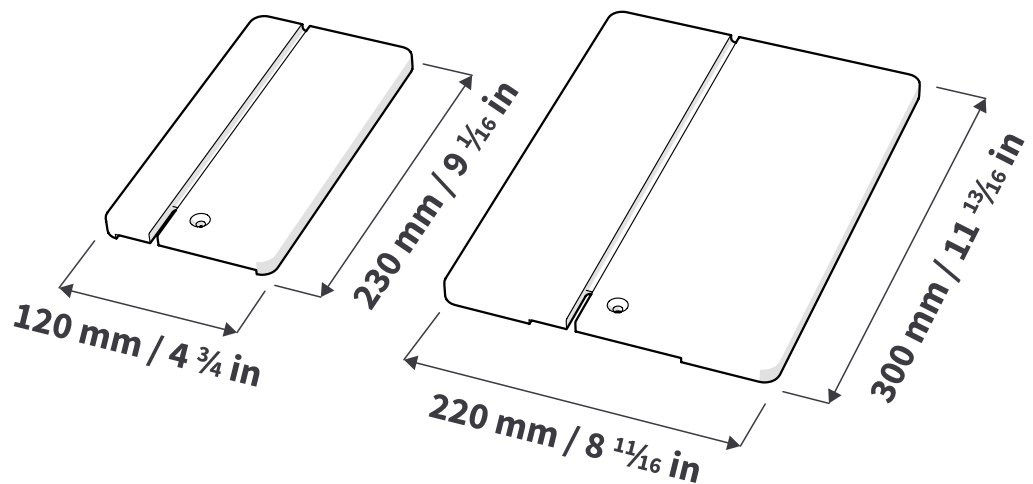

2. Remove the strike plate from the frame.

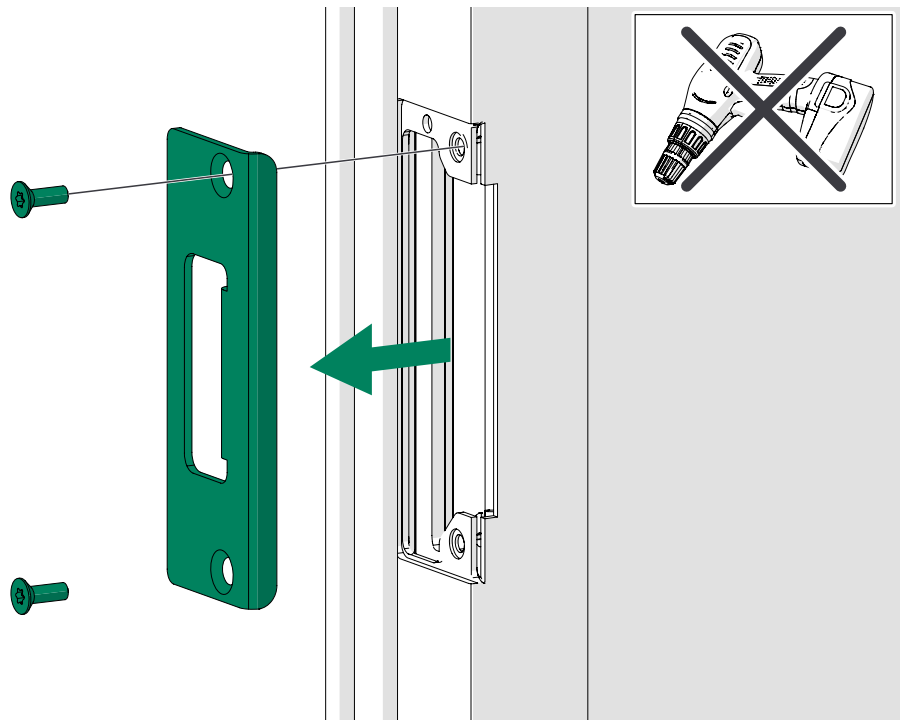

3. Measure the correct place for the rubber spacer on the chosen wooden back plate and install with one 4x20 screw.

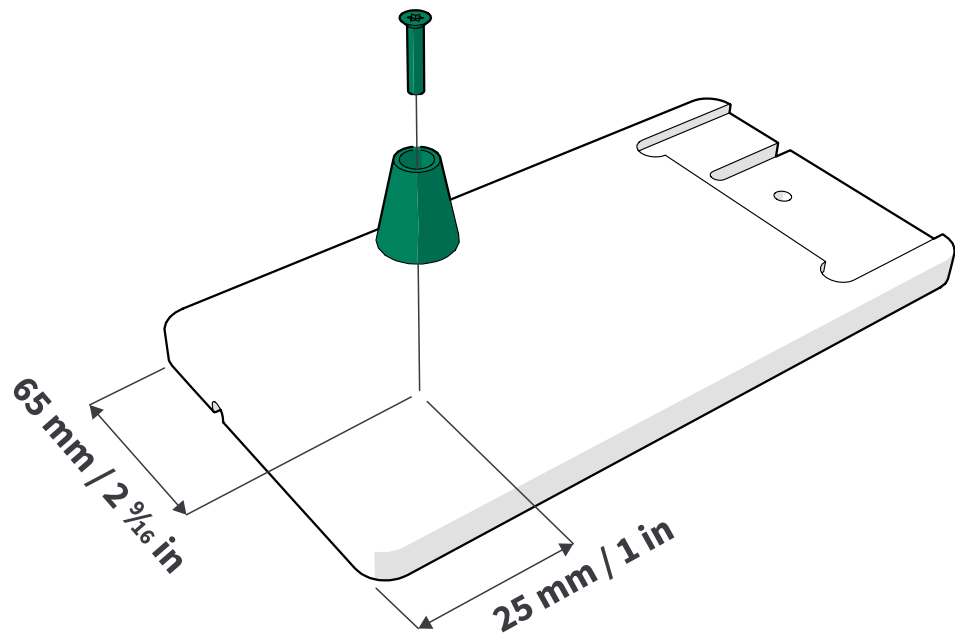
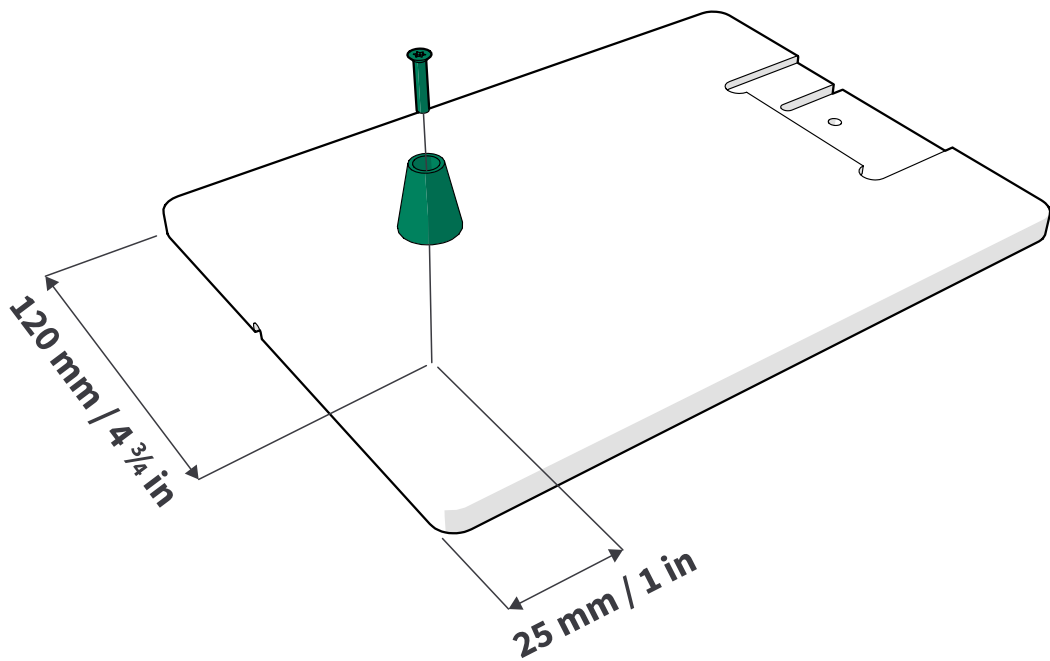

4. Guide the customer supplied cord through the frame.

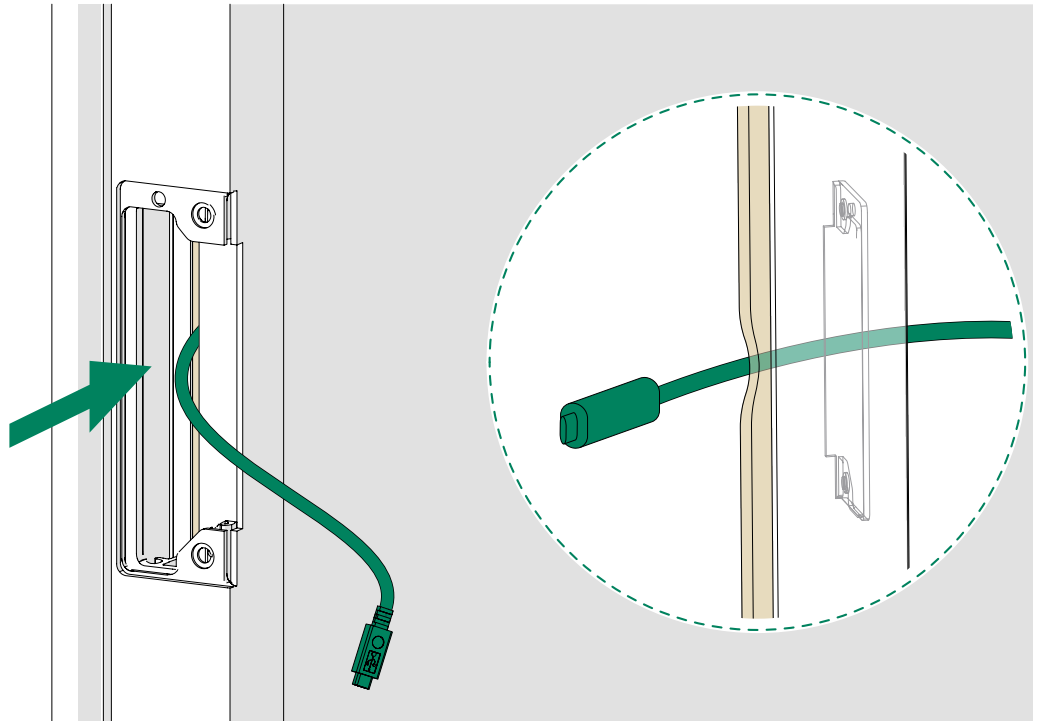

5. Assemble the tablet mount with one M6x30 screw and one M6 barrel nut. Hold the nut in the slot while tightening the screw

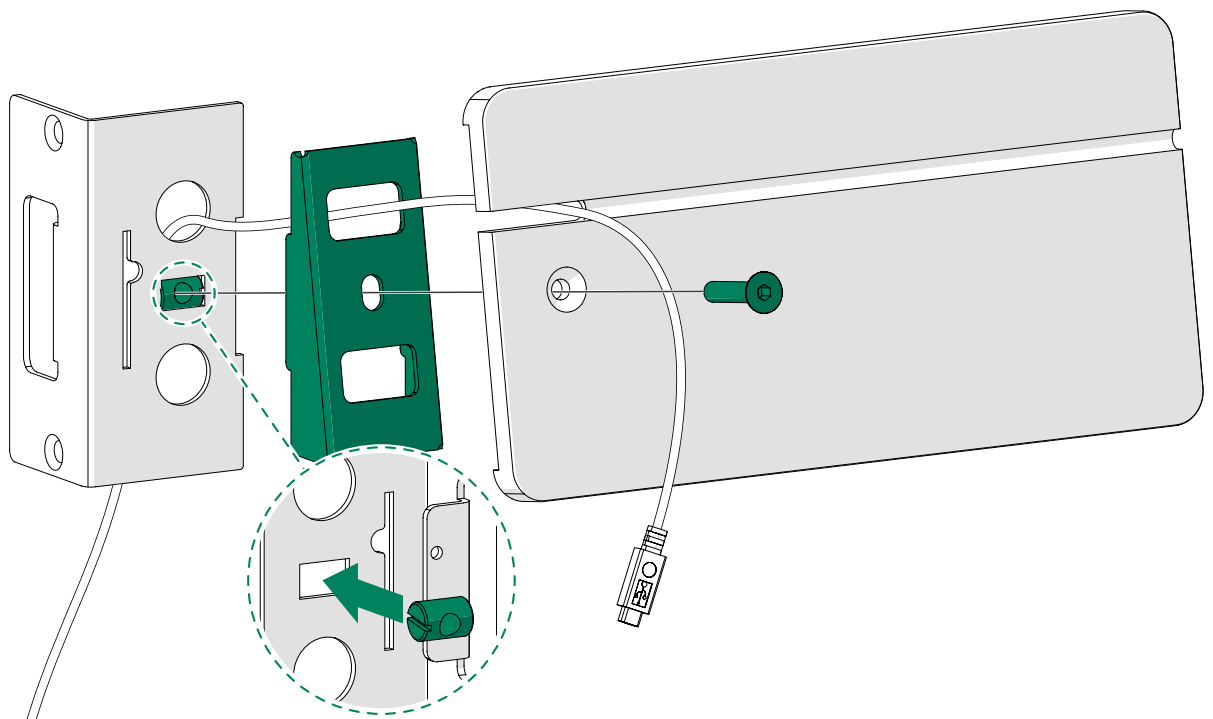

6. Install the strike plate with tablet mount to the frame.



Note: Make sure that you leave enough cord on the outside to reach the customer supplied tablet.

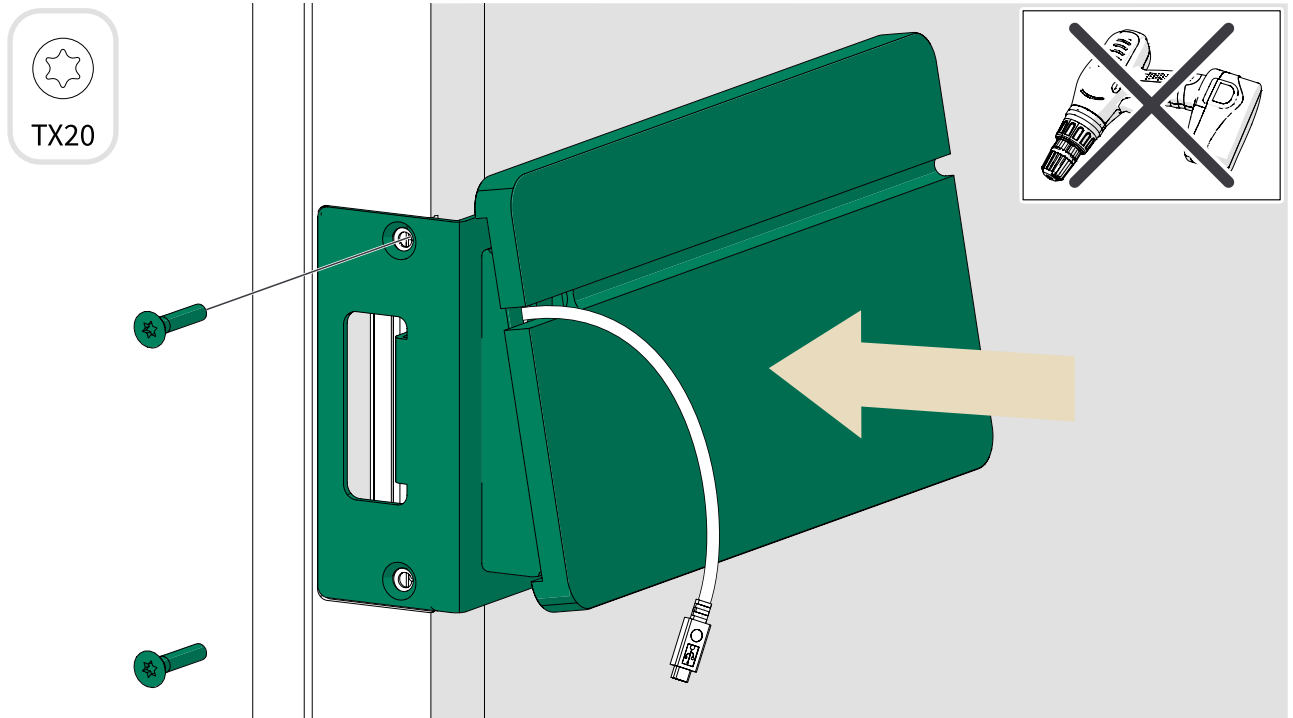

7. Install the tablet holder to the back plate with the wood screws provided (4 pcs).



Note: The tablet holder is customer supplied and not included in the package.

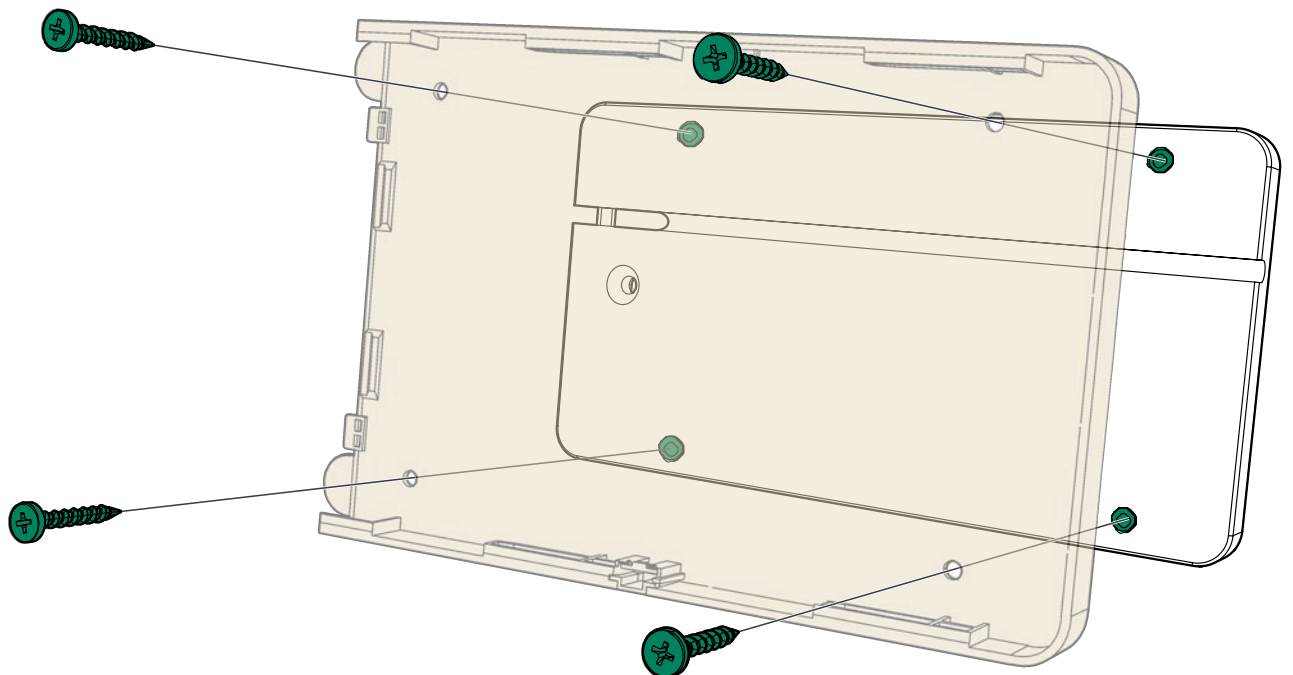

8. Route the cord under the gasket all the way up to the ceiling and connect it to the core unit.

If the pod is already fully assembled, remove the lights and ceiling interior panels to access the core unit.

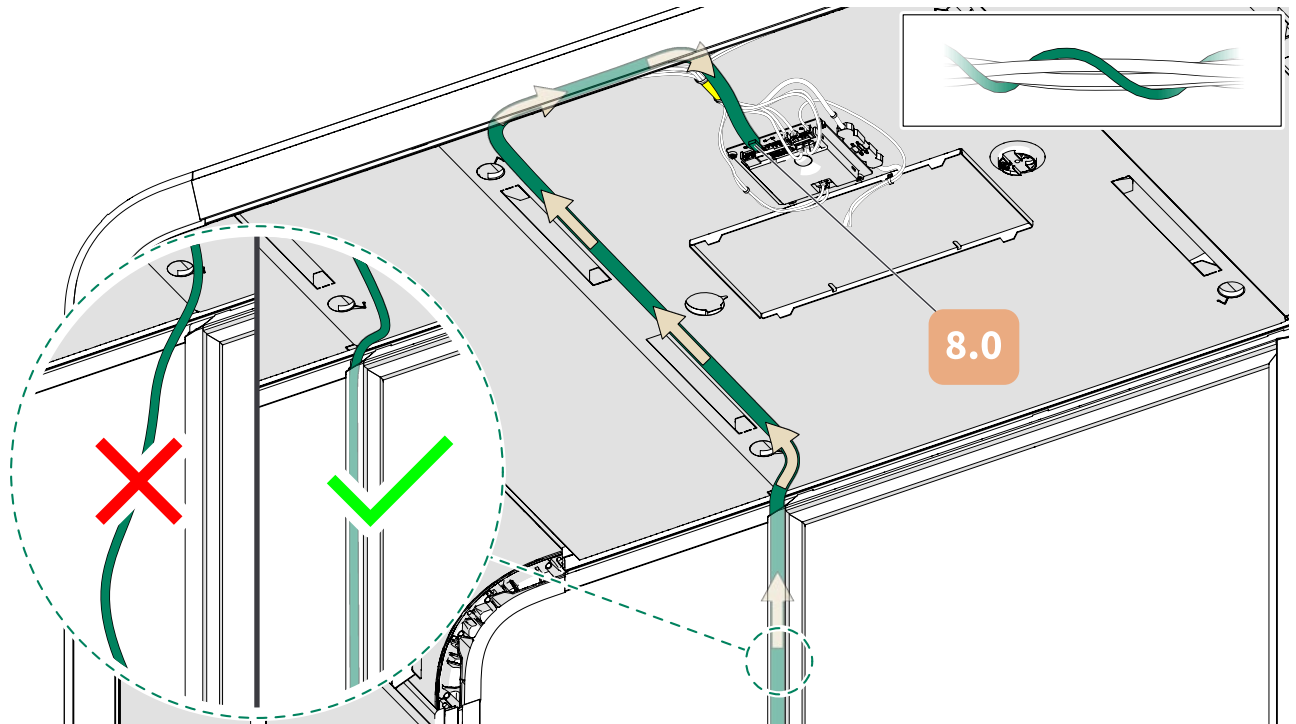

9. If the tablet is powered by some other cord than USB-C, guide the cord down or up along the frame and out of the pod through the same opening as the pod power cord.

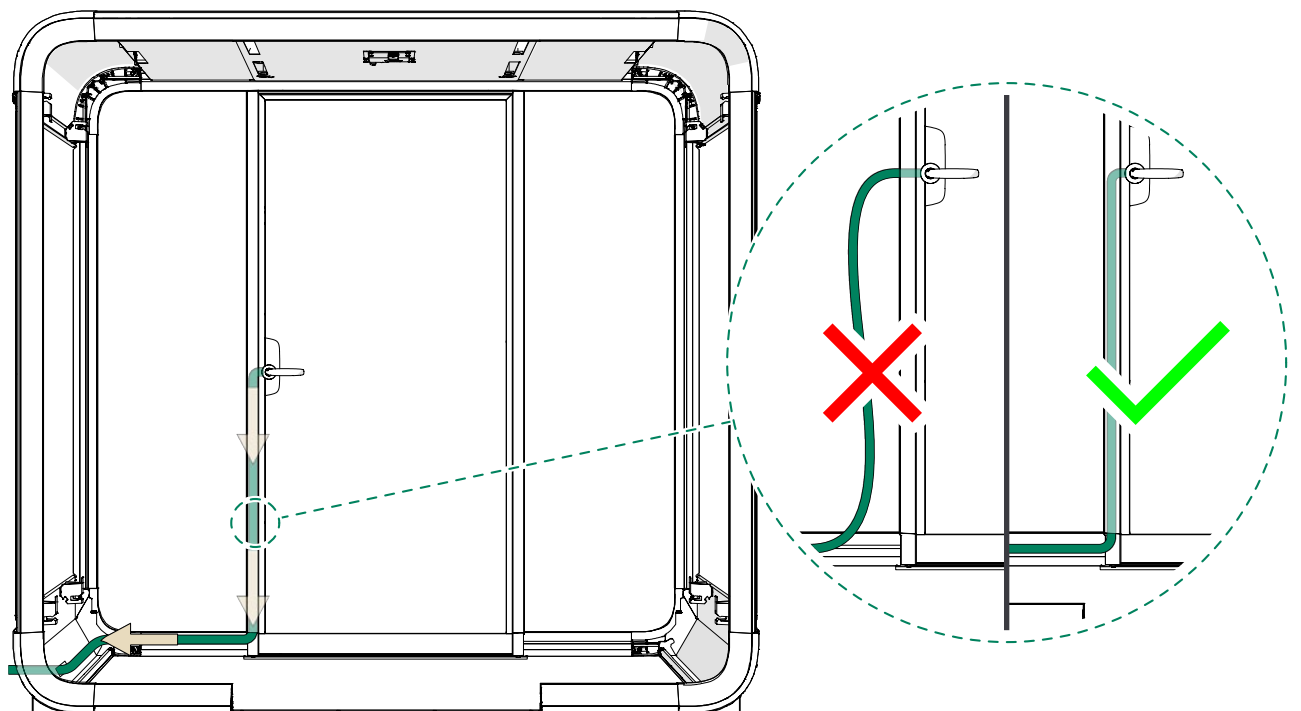

framery

Exterior tablet mount

Installation instructions

Patamäenkatu 7

33900 Tampere

FINLAND

VAT: FI 23527139