



Framery One

Seismic kit installation instructions

English
Version 1.2

Tampere, Finland 29.04.2025

9012815

Contents

1 Important safety and product instructions.....	5
1.1 Preface.....	5
1.2 Product information.....	5
1.3 Copyright.....	5
1.4 Manual contents.....	5
2 Seismic anchoring requirements.....	6
3 Required space with seismic anchoring.....	7
4 Minimum embed depth / bracket thickness.....	8
5 Seismic anchor locations - dimensions.....	9
6 Seismic kit contents.....	10
7 Tools required.....	11
8 Install the seismic anchoring (alcove and close to wall anchoring).....	12

1 Important safety and product instructions

1.1 Preface

This instruction manual describes the installation of the product. Everyone involved in installing the product must read and understand the contents of the installation and safety instructions.

This instruction manual gives you necessary information for the correct installation of the product.

For complete product and safety instructions, see **help.framery.com**.

1.2 Product information

The information in this manual corresponds to the product at the time of delivery. All information included in this manual is valid at the time of publication.

1.3 Copyright

This document must not be copied, presented, or delivered to a third party without explicit permission from Framery. The use of this document for any purpose other than those allowed by Framery is prohibited. Framery reserves the right to change the instructions related to the product without separate notice.

1.4 Manual contents

The installation instructions contain the following information:

- General information about the purpose and content of the instructions
- Information related to safety
- Installation instructions

2 Seismic anchoring requirements

**Note:**

When installing the product, take into consideration all local laws, rules and regulations concerning seismic anchoring and seismic safety.

For installations in the U.S., in buildings located in Seismic Design Categories A and B, anchoring to the floor is optional. In buildings located in Seismic Design Categories C, D, E or F, anchoring to the floor is required.

When anchoring to the floor, plans that address seismic design categories must be prepared by a registered design professional. The plans are to include definitions on the type, size and location of anchors and installation limitations. Additionally, installation must be in accordance with the applicable codes [IBC, IFB, IMC, NFPA 70 and, when installed with a sprinkler, NFPA 13].

3 Required space with seismic anchoring

When the pod is installed in a tight space or several pods are installed tightly next to each other, the required space on both sides of the template is at least 5 mm (0.2 in) and 10 mm (0.4 in) on the backside of the template.

! **Note:** In this case the pod electrics cannot be accessed after installation. The functionality of pod electrics must be checked before the pod is pushed to the final location.

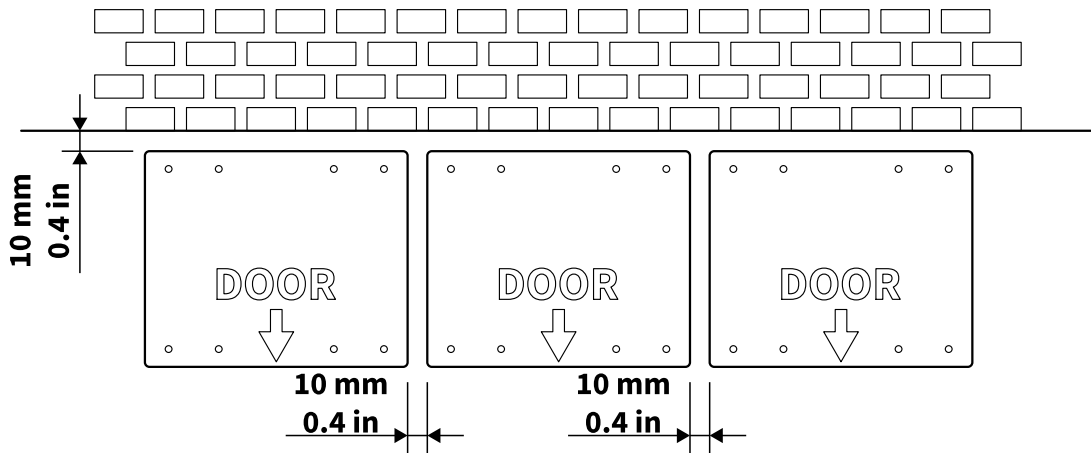

Figure 1: Required operating space with seismic anchoring (tight installation).

If space is not limited, the recommended space on the techwall side of the pod is at least 50 cm (20 in). This is to ensure that all electrical components of the pod can be accessed for maintenance or replacement purposes.

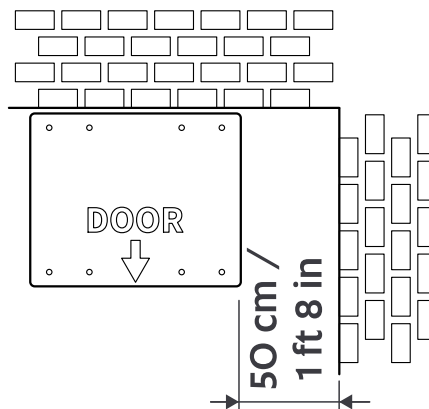

Figure 2: Required operating space with seismic anchoring.

4 Minimum embed depth / bracket thickness

Anchor bolt length is determined by minimum embed depth (ed) + Bracket thickness (bt) + nut/washer thickness (nw). Total Anchor Length = "ed"+"bt"+"nw"

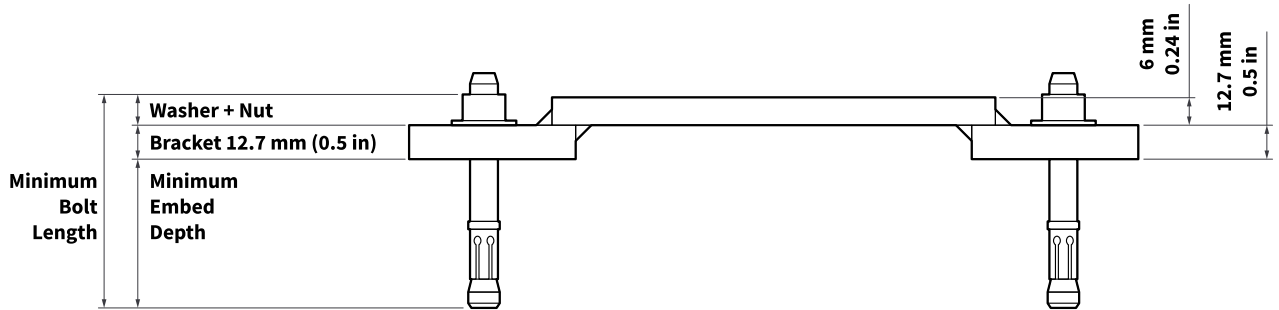

Figure 3: Anchor bolt length

5 Seismic anchor locations - dimensions

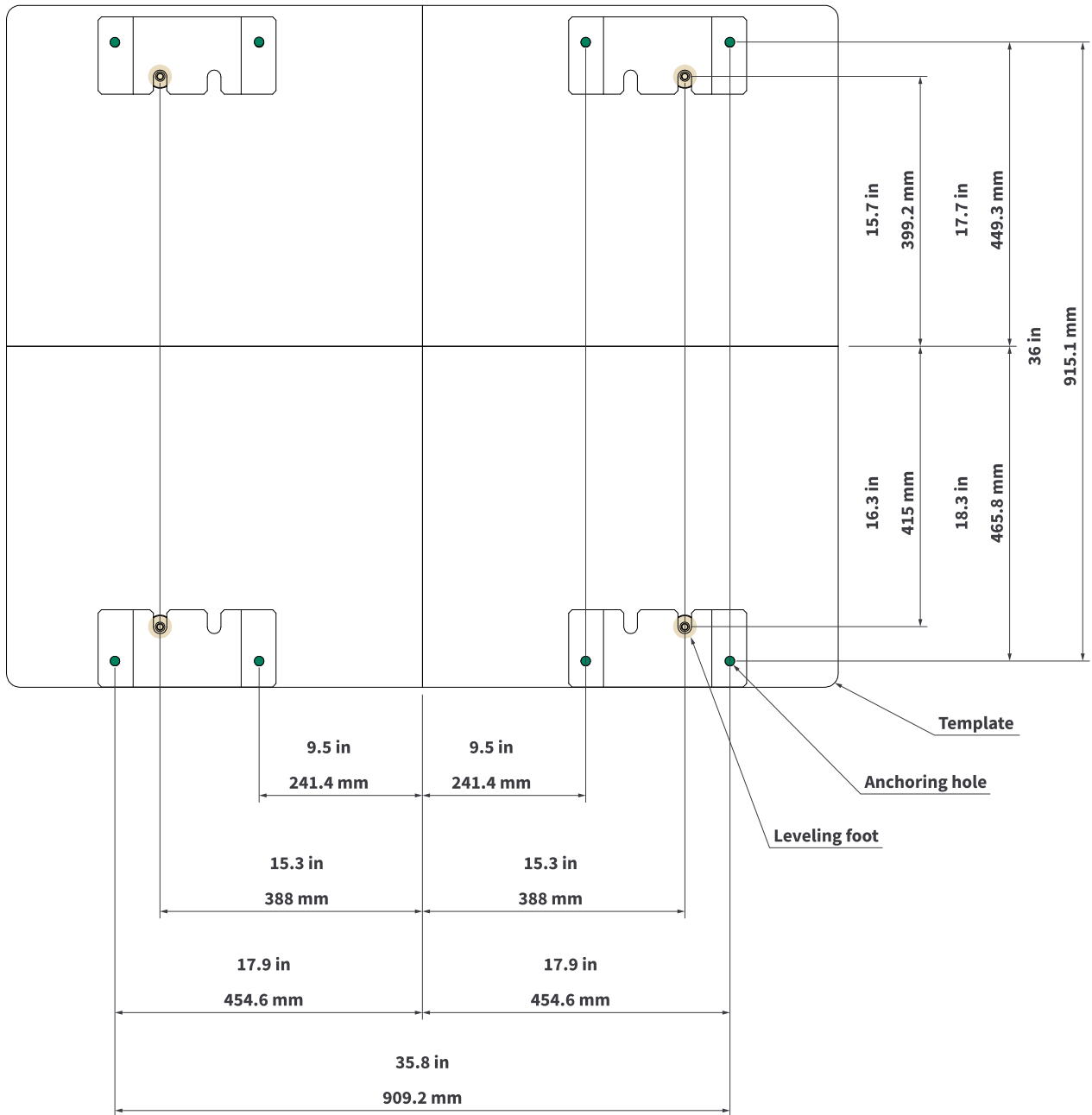

Figure 4: Framery One anchor locations

6 Seismic kit contents

Seismic anchors are NOT included in the seismic installation kit. Seismic anchors must be selected and sized by a licensed Professional Engineer based on the floor construction of the building in which the pods are installed.

⚠ **Note:** Special inspection also may be required depending on the requirements of the local jurisdiction.

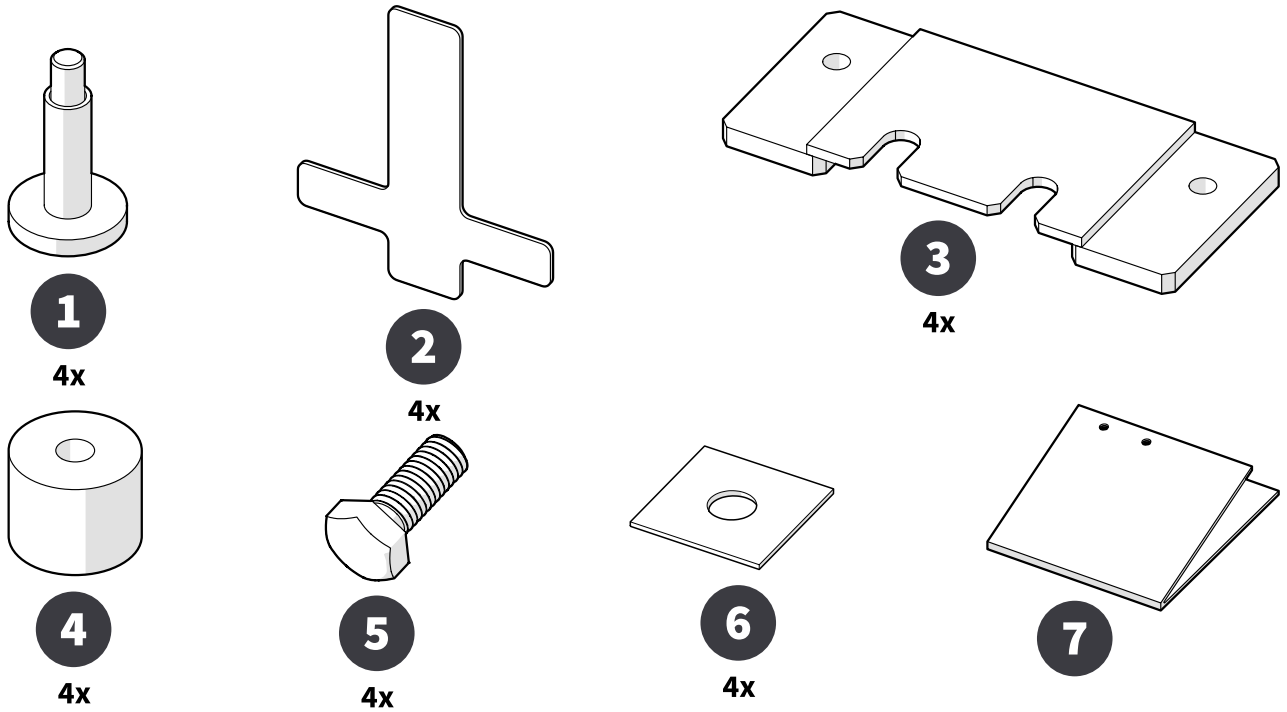

Figure 5: Framery One seismic kit

Number	Pcs	Description
1	4	Leveling foot
2	4	Bracket for wall body cover
3	4	Seismic anchoring bracket
4	4	Caster bushing
5	4	M8x20 bolt
6	4	Seismic proofness plate
7	1	Template

7 Tools required



Note: Rotary hammer drill is recommended for drilling into concrete. Drill bit size is based on the anchor selected.

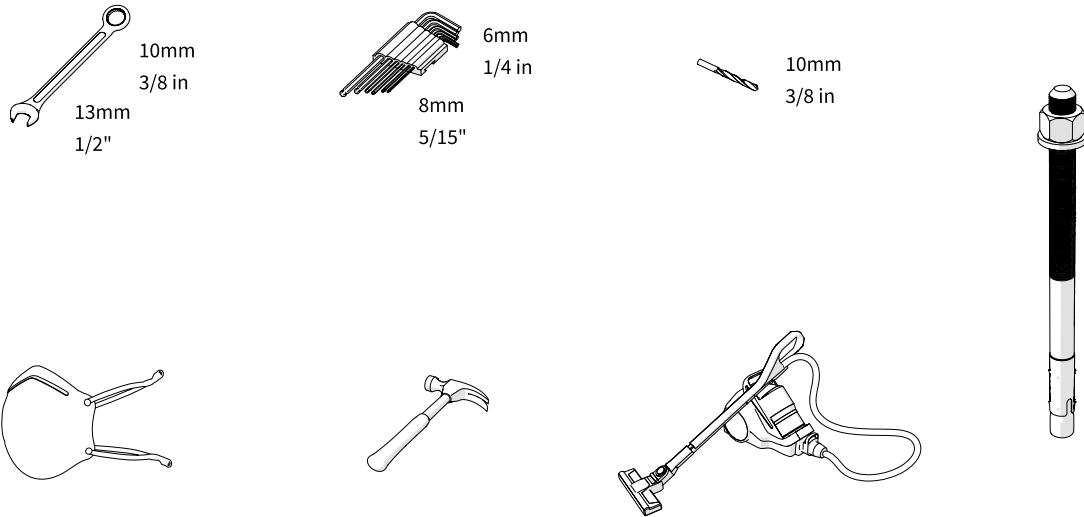

Figure 6: Tools required for seismic anchoring

8 Install the seismic anchoring (alcove and close to wall anchoring)

The following steps instruct seismic anchoring of the pod in cases where the pod is installed in an alcove, close to a back or side walls.

1. Place the template at the intended final location of the pod.
2. Using the holes in the template as reference, drill holes for the anchors.

Verify the required hole depth with anchor guidelines.

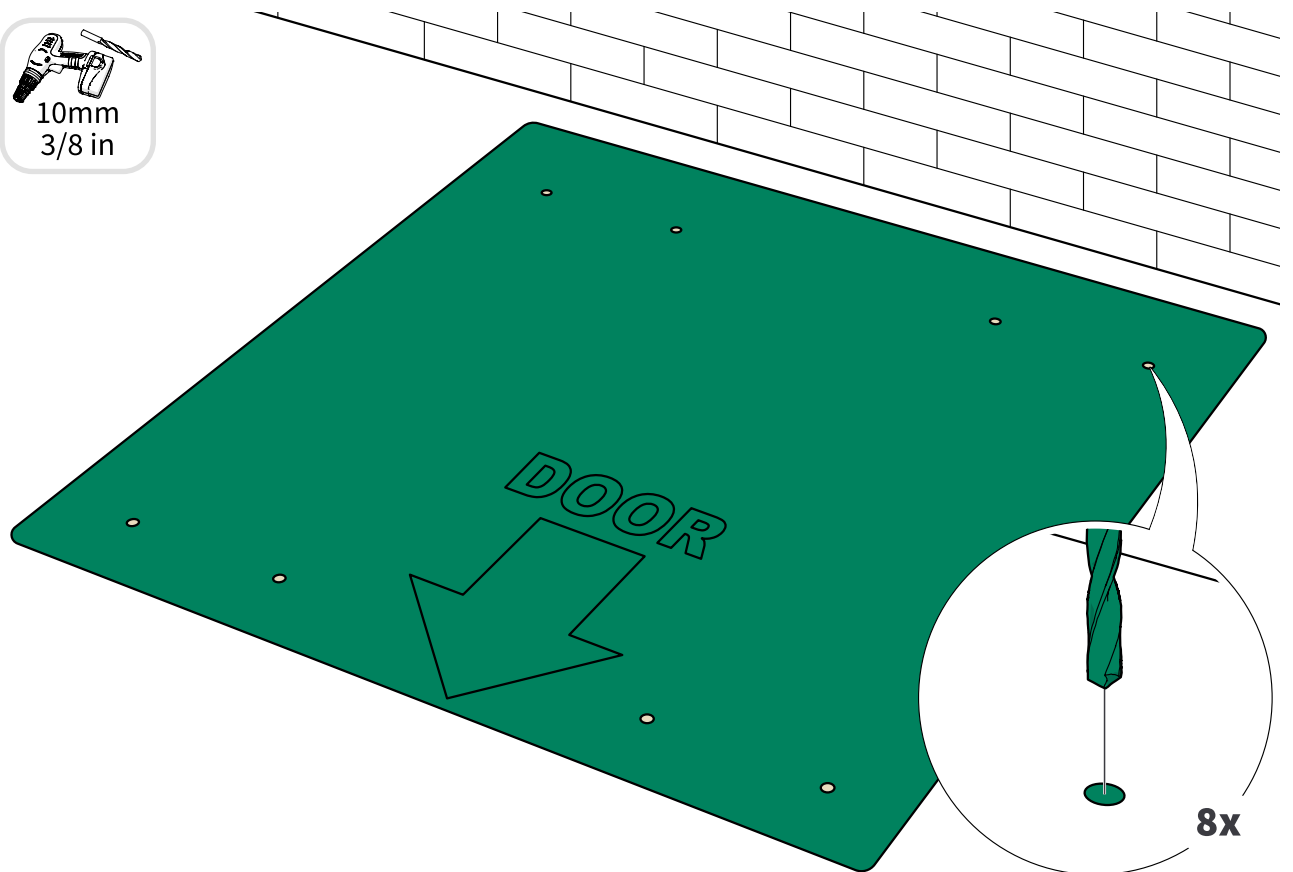

3. Clean the drilled holes according to anchor guidelines.

4. Insert all eight anchors into the holes. Install two of the seismic anchoring brackets for the backside of the pod (next to the wall).

The thickness of the seismic anchoring brackets is ½ in (12.7 mm).

The hole diameter in the brackets is 0.55 in (14 mm).

⚠ **Note:** The anchors must protrude minimum 1 in (25 mm) from the floor to properly attach to the seismic anchoring bracket.

⚠ **Note:** The nut and washer size depend on the anchor selected.

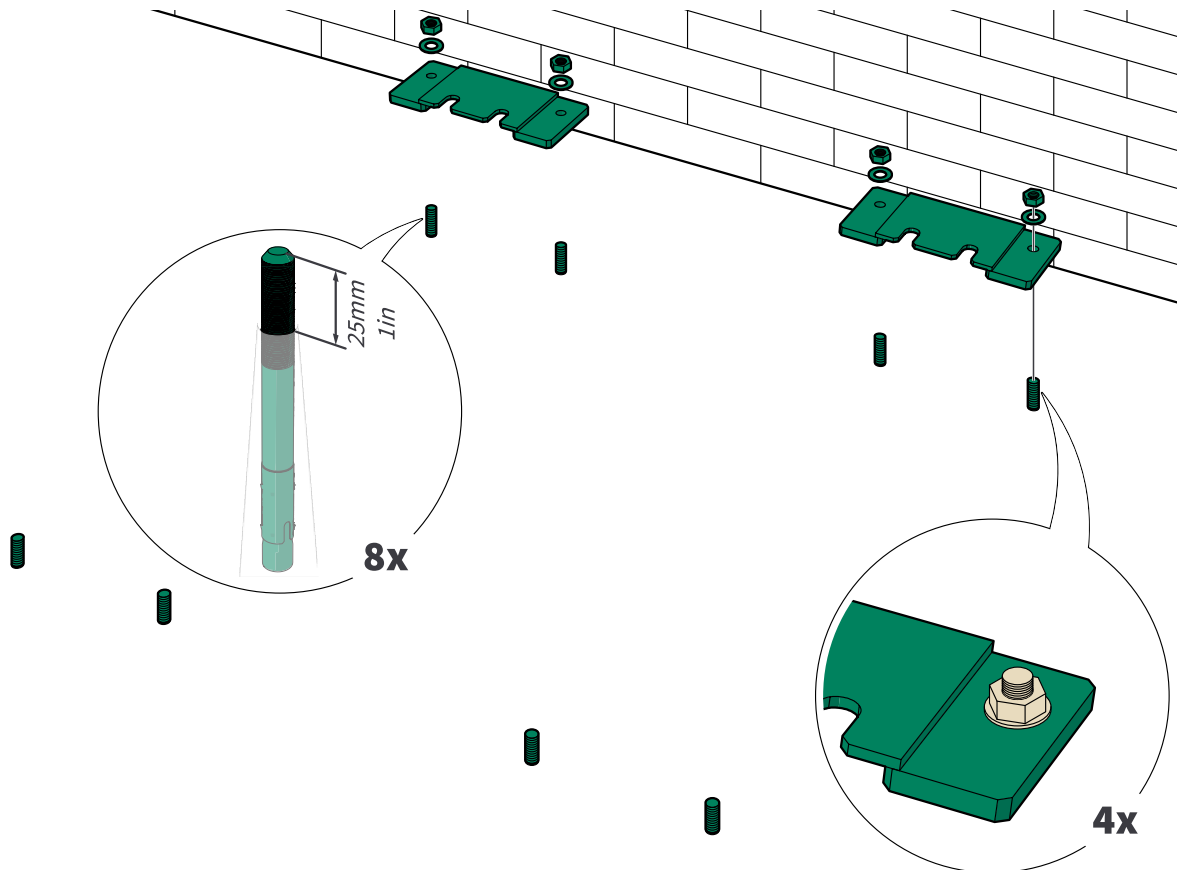

5. The anchors should be torqued to bolt manufacturer's guidelines. It is important to check both the bolt manufacturer's literature and the Professional Engineering calculations for this project.

6. Install the leveling feet to the pod floor.

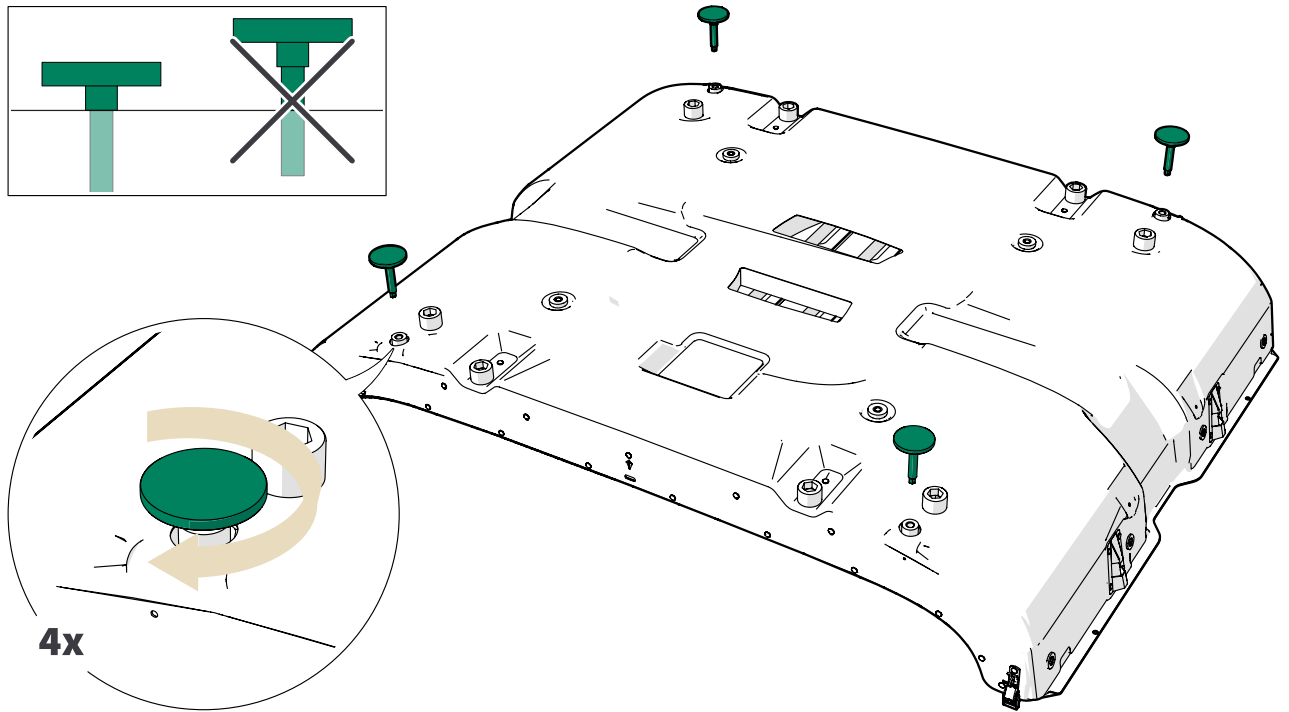

7. Install the casters to the pod floor.

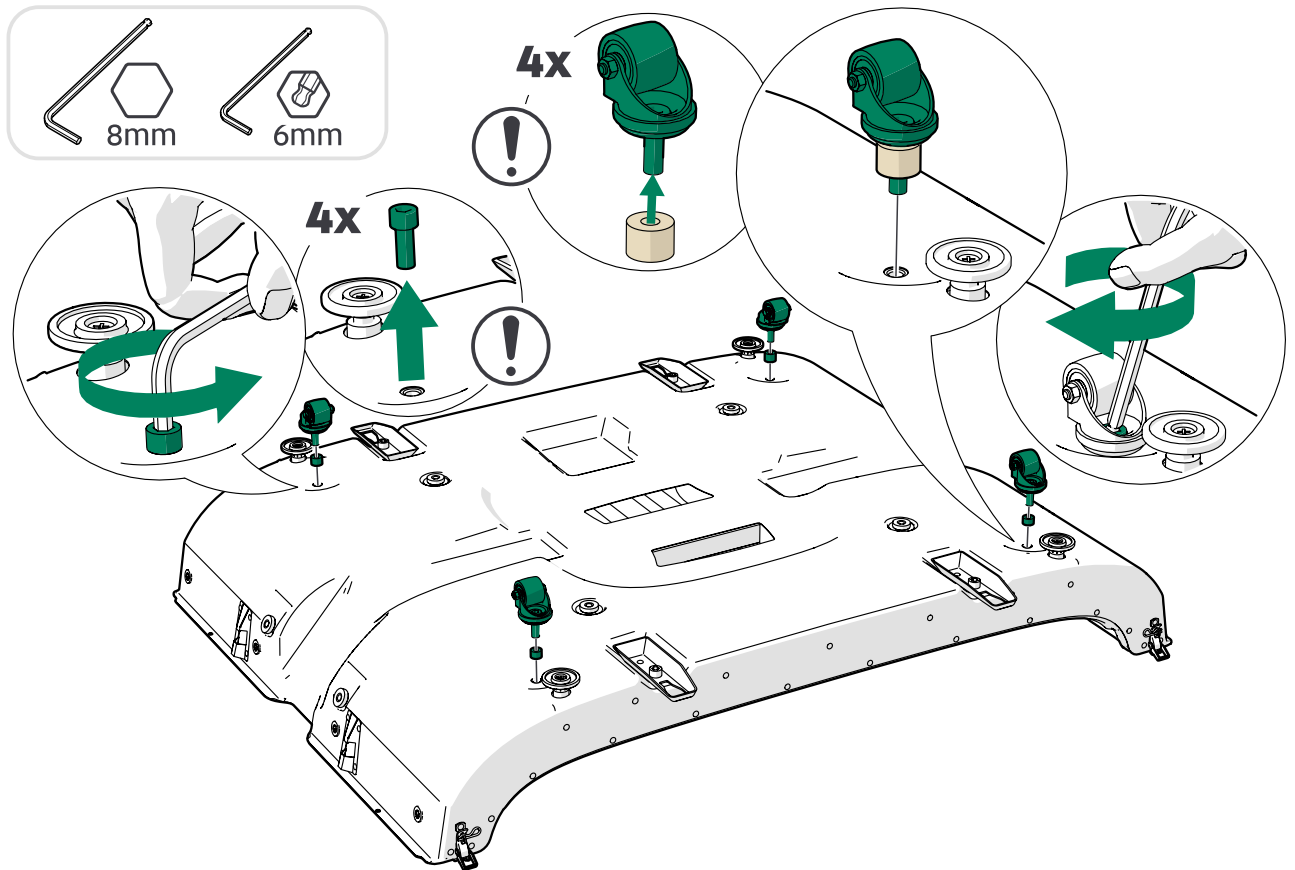

8. Assemble the pod normally according to the installation instructions.

9. Before installing the floor body covers, install the seismic proofness plates.

⚠ **Note:** Do not apply a torque greater than 15 Nm.

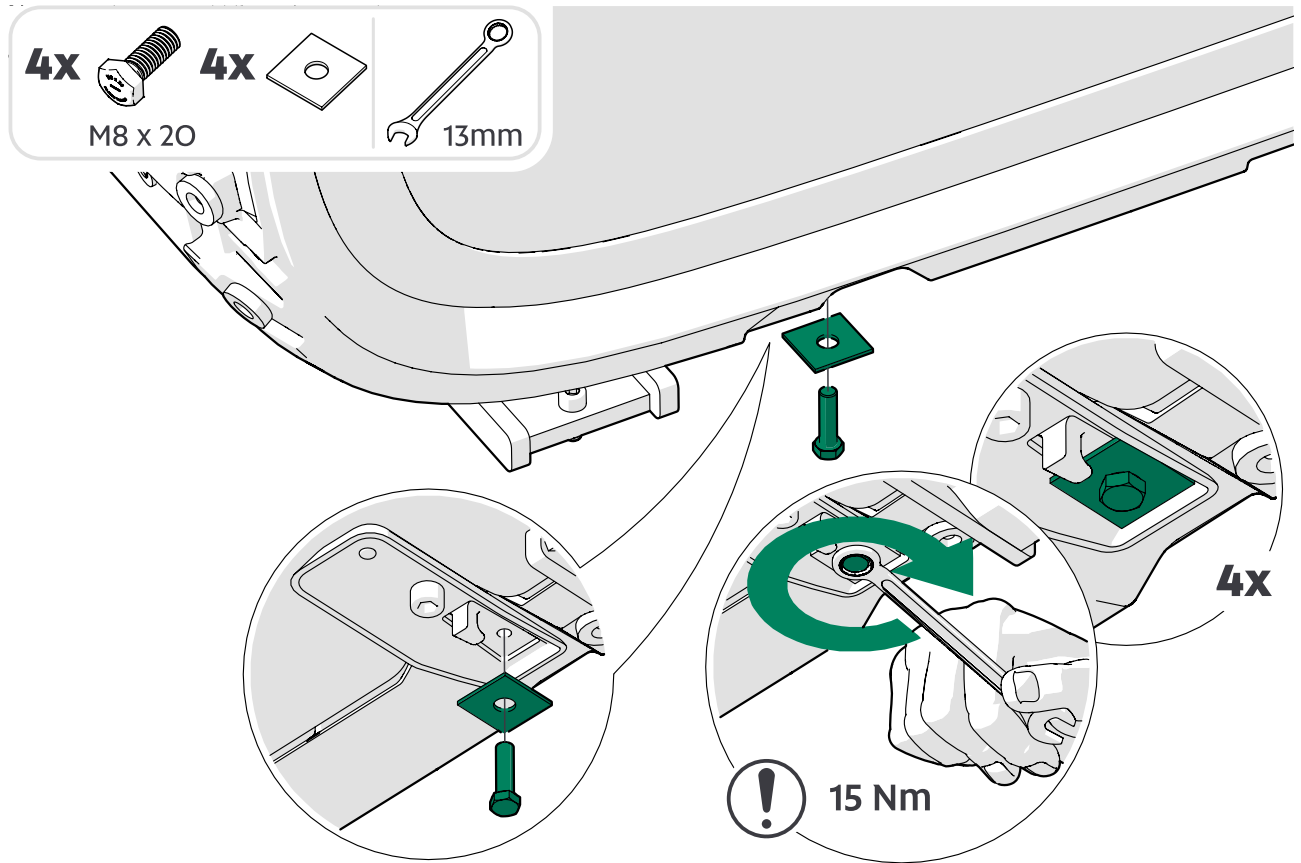

10. Install the floor body covers.

11. Install the brackets for the wall body covers.

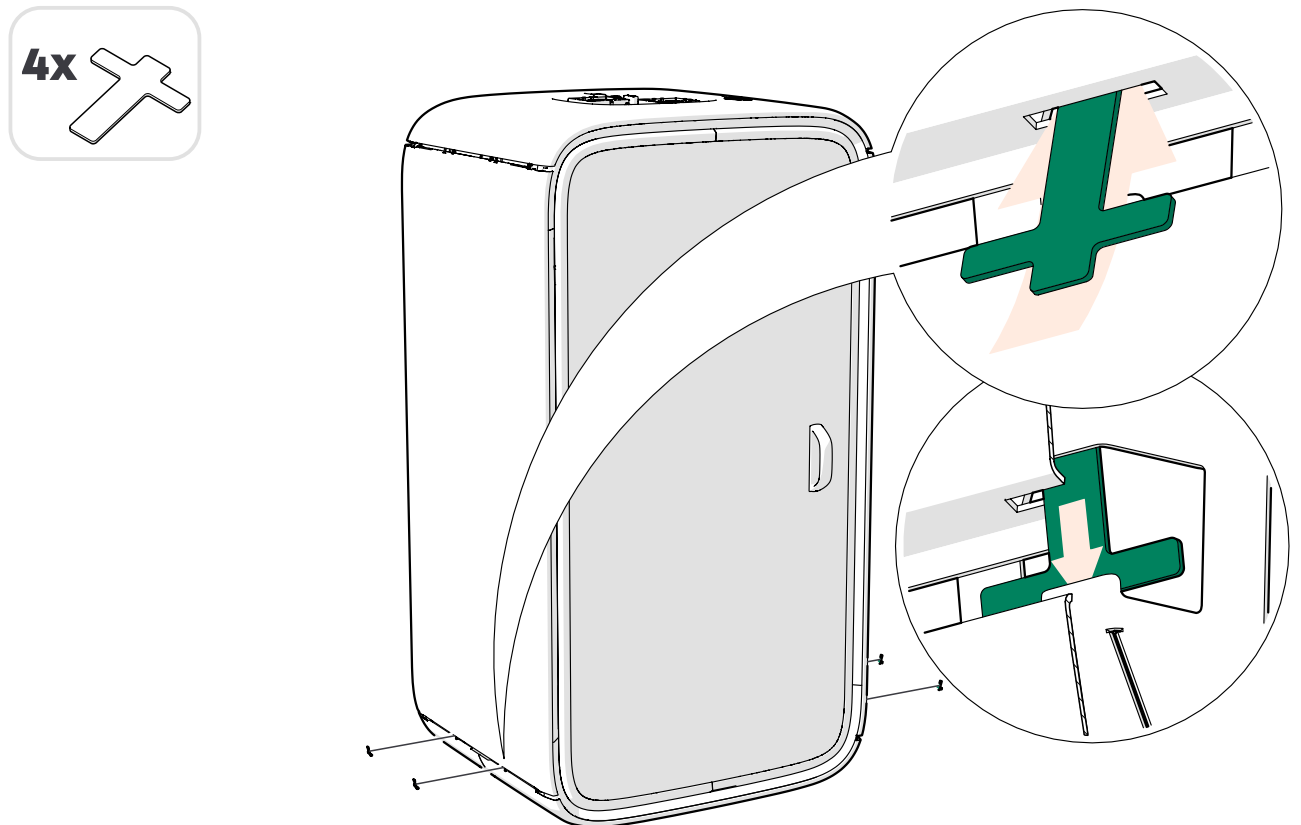

12. Install the plastic trims and fan cover.
13. Carefully push the pod to the final location so that the feet in the backside of the pod are in the recesses of the anchoring brackets.

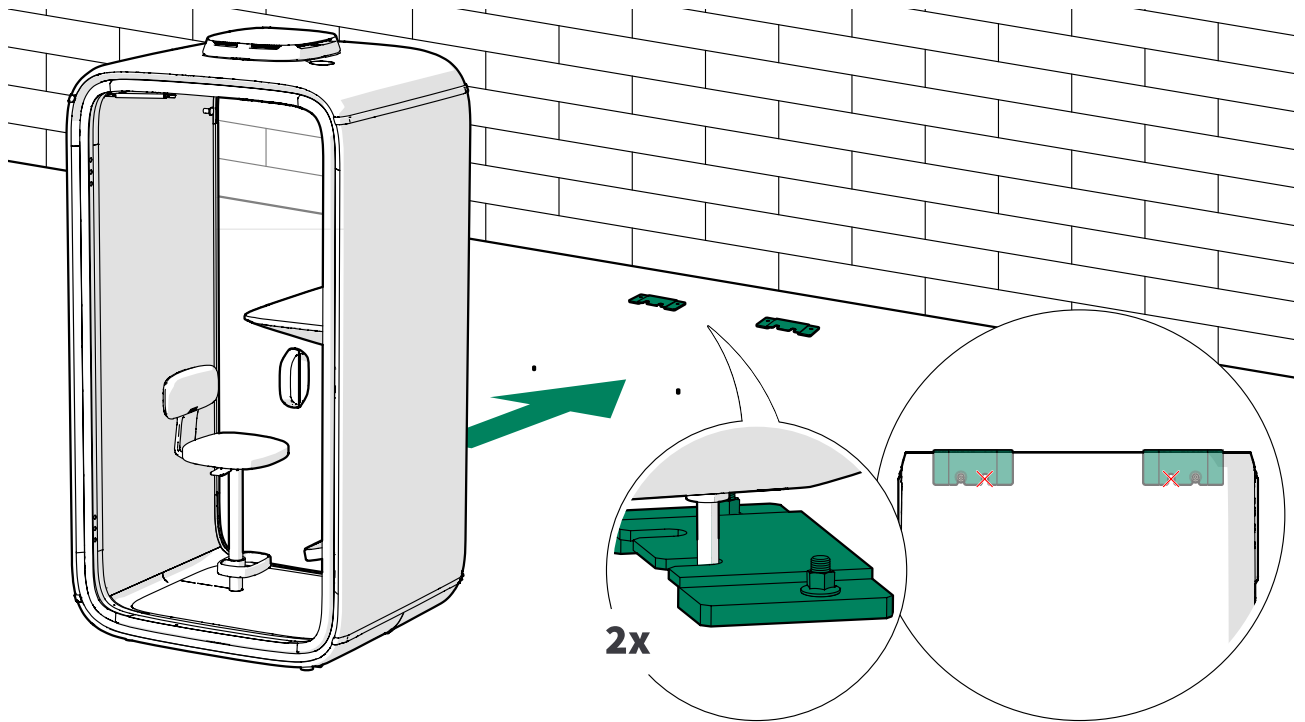

14. Install the seismic anchoring brackets to the front of the pod.

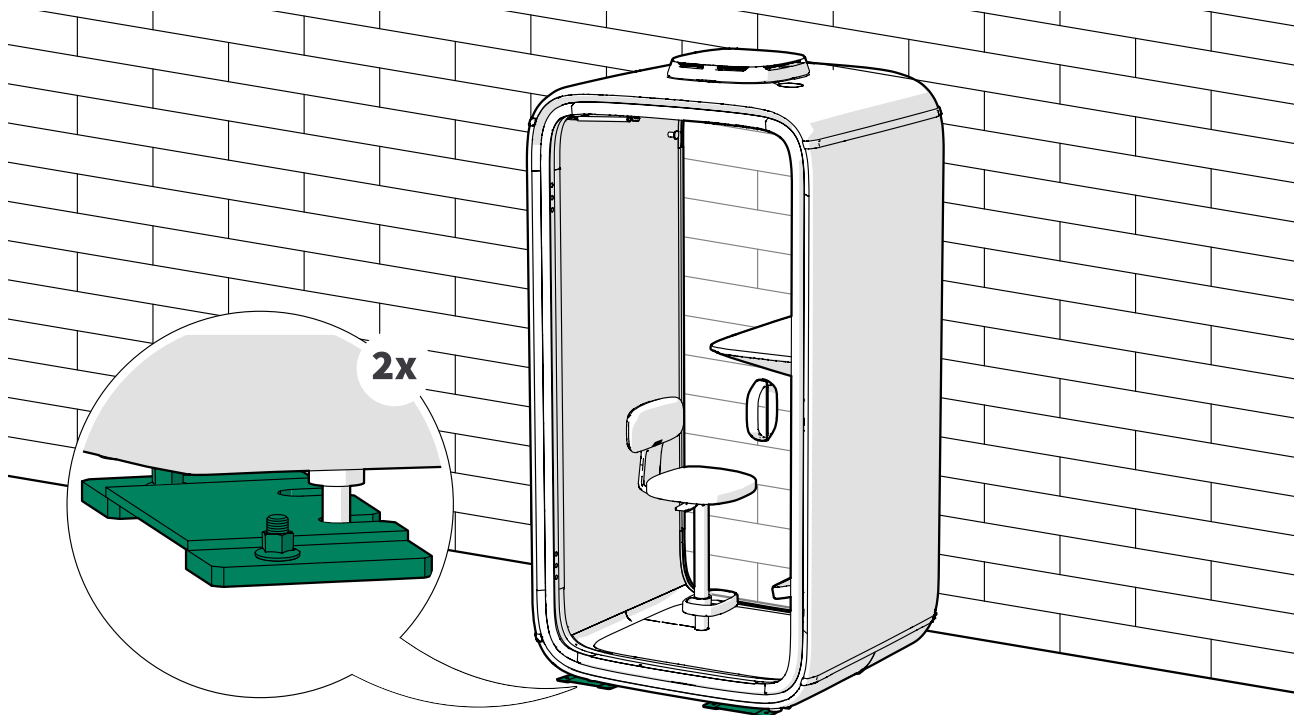

framery

Framery One
Seismic kit installation instructions
Patamäenkatu 7
33900 Tampere
FINLAND
VAT: FI 23527139